

**Mark your calendars...**

# **2018 Wisconsin Aviation Conference**

**Wisconsin Dells, Wisconsin**

**May 7 - 9, 2018**

**For additional information about exhibiting, sponsoring,  
speaking or simply attending next year's Conference in  
Wisconsin Dells, please contact Bob O'Brien, AAE at  
[director@wiama.org](mailto:director@wiama.org)**



# **2017 Wisconsin Aviation Conference**

**April 24 – 26, 2017 • Waukesha, Wisconsin**

**Thanks to the following people who helped make the  
2017 Wisconsin Aviation Conference a success:**

Ismael Bonilla	Dave Jensen	Charles Sweet, III
Bruce Botterman	Bill LeGore	Clint Torp
Scott Brummond	Peter Moll	Abe Weber
Ron Burdick	Marty Piette	Charity Zich
Matt Dean	Bob O'Brien	Helena Ziegler
Jeff & Liz Gaier	Kurt Stanich	
Brian Grefe	Paul Strege	

**Please take the time to visit and thank the  
2017 exhibitors and sponsors. Their support  
is what makes your conference possible.**

**THANK YOU TO OUR  
CORPORATE EXCELLENCE SPONSORS**

*for making this Conference possible.*

**ATLANTIC**

**Mead  
& Hunt**

*Signature*<sup>®</sup>

**FLIGHT SUPPORT**

**BBA Aviation**<sup>®</sup>

**BECHER HOPPE**

**330 N. 4th Street  
Wausau, Wisconsin 54401-5417  
715-845-8000**

*Program printing courtesy of Becher-Hoppe Associates, Inc.*



# Welcome to the 62nd Annual Wisconsin Aviation Conference

Welcome and thank you for attending Wisconsin's premier professional aviation event! This year's conference committee worked hard to improve the schedule and provide you with unique opportunities to meet, discuss, and exchange ideas and information with our gathering of consulting engineers and suppliers; airport managers, staff and commissioners; general aviation and corporate pilots; FBOs; and federal and state aviation officials. We encourage you to share your expertise and help shape aviation in Wisconsin now and into the future.

The support and participation of our sponsors, contributors and exhibitors is what makes your conference possible. They are invested in your success and in the future of Wisconsin's aviation industry. Please take every opportunity to visit the exhibit area, view the products and services that are showcased for you, and thank them for partnering with us.

Have a great conference and mark your calendars for the 63rd Wisconsin Aviation Conference in Wisconsin Dells, Wisconsin, May 7-9, 2018!

Sincerely,

Your Wisconsin Aviation Conference Co-Sponsors:

**Wisconsin Airport Management Association**

**Wisconsin Aviation Exhibitors and Consultants Association**

**Wisconsin Aviation Trades Association**

**Wisconsin Business Aircraft Association**

# ***Monday, April 24***

**8:00 a.m. – 4:00 p.m.**

**On-Site Conference Registration**

**Grand Ballroom Foyer**

**Coordinator:** Jeff and Liz Gaier, Marshfield Municipal Airport

**8:00 a.m. – 12:00 p.m.**

**Exhibitor Set-Up**

**Grand Ballroom**

***Sponsored by: Pewaukee/Waukesha Convention & Visitors Bureau***

**10:30 a.m. – 11:30 a.m.**

**Grand Salon**

**Opening General Session**

**AeroMedical Reforms and Learning to Fly without a 3<sup>rd</sup> Class**

**Medical**

Recent legislation to update and reform medical requirements for piloting an aircraft has energized the aviation community. The information provided by experts in this field will be valuable to everyone as we continue to promote the aviation industry.

**Speakers:** Sean Elliott, EAA VP Industry & Regulatory Affairs

Tom Charpentier, EAA Government Relations Director

**Coordinator/Moderator:** Peter Moll, Airport Director,  
Wittman Regional Airport

***Sponsored by: Wittman Regional Airport***

**11:30 a.m. – 1:00 p.m.**

**Lunch**

**Grand Salon**

Boxed lunch available for those attending sporting events.

***Sponsored by: Oshkosh Airport Products and  
Bruce Municipal Equipment***

Conference transportation

***Sponsored by: Shell Aviation & Eastern Aviation Fuels***





# Aviation Award Past Recipients

## Person of the Year Award

1969	S. J. Wittman	2013	Not Awarded
1970	Howard Morey	2014	Abe Weber
1971	Francis Higgins	2015	Ben DeLeon
1972	No Conference	2016	Not Awarded
1973	T. K. Jordan		
1974	Ed Williams		
1975	Marie Grimm		
1976	Robert Heck		
1977	Paul Poberezny		
1978	Roy Shwery		
1979	Dave Duax		
1980	Basil Arvey		
1981	Marilyn Hardacre		
1982	Joe Liebergen		
1983	Wally Mitchell		
1984	Preston Wilbourne		
1985	Fred Gammon		
1986	George McQueen		
1987	LeRoy Jonas		
1988	James Ash		
1989	Art Borchardt		
1990	Timothy Hoeksema		
1991	Charles E. Swain		
1992	Tom Poberezny		
1993	Lyle Maves		
1994	Dennis Eiler		
1995	James Conn		
1996	C. Barry Bateman		
1997	Peter Drahn		
1998	James Hansford		
1999	Joseph Brauer		
2000	Diane Ballweg		
2001	Don Hoeft		
2002	Not Awarded		
2003	Jeff Baum		
2004	Russ Decker, Mark Meyer		
2005	Marty Lenss		
2006	Not Awarded		
2007	Tony Yaron		
2008	James Kerr		
2009	Jeff Skiles		
2010	Rose Dorcey		
2011	Tom Miller		
2012	Michael Goc		

## WAMA Distinguished Service Award

2000	Don Hoeft Phill Scherer
2001	Irene Enamual
2002	Thom Thomas
2003	Gary Dikkers
2004	Peter Drahn
2005	James Hansford, Ray Perry, Marilen Butler
2006	Dave Johnson
2007	John Chmiel, Ruth Elliott, Patrick Mattson
2008	Jeff Gaier, Helena Ziegler
2009	John Dorcey
2010	Clint Torp
2011	David Obey
2012	Matt Dubbe
2013	Marty Lenss
2014	Not Awarded
2015	John Reed
2016	Allan Seirstad, Dave Elder

## WAMA Blue Light Award

2013	Meg Jones
2014	Not Awarded
2015	Chris Hubbuch

## WAMA Green Light Award

2014	Barry Bateman
------	---------------

**12:00 p.m. – 4:30 p.m.**

**Golf Outing**

**Western Lakes Golf Course**

***Sponsored by: Hinshaw & Culbertson, LLP***

**Coordinator:** Ron Burdick, Airport Manager,  
Southern Wisconsin Regional Airport

If taking bus, meet in hotel lobby no later than 11:50, otherwise meet at course at 12:30.

GPS Address: W287 N1963 Oakton Rd | Pewaukee, WI 53072

**12:00 p.m. – 4:30 p.m.**

**Sporting Clays**

**McMiller Sports Center**

***Sponsored by: Becher-Hoppe Associates, Inc.***

**Coordinator:** Clint Torp, CM, Airport Director, La Crosse Regional Airport

If taking bus, meet in hotel lobby no later than 11:50, otherwise meet at course at 12:30.

GPS Address: S103 W38754, Hwy NN | Eagle, WI 53119

**1:00 p.m. – 4:00 p.m.**

**One – on – One “Speed Dating” between Airports and the Chicago Airports District Office**

This is your opportunity as an airport sponsor to meet face-to-face with representatives of the Chicago Airports District Office (ADO) about issues specific to YOUR airport.

**FAA Program Managers:** Mike Ferry, Executive Learning Center 3  
Rob Lee, Executive Learning Center 4

***Sponsored by: Wisconsin Airport Management Association (WAMA)***

**1:00 p.m. – 4:00 p.m.**

**Country Springs Hotel – Airport Equipment Showcase**

The Wisconsin Airport Management Association brings state-of-the-art equipment to the Country Springs Hotel. You'll have the opportunity to view the equipment, talk with factory representatives, and ask specific questions of manufacturers in a casual, relaxed atmosphere. The showcase exhibitors will display and demonstrate a wide variety of equipment, including snow removal vehicles and operations and maintenance equipment. This showcase is specifically designed for anyone involved in airport management, operations, and maintenance, including, those who purchase, use, maintain, and repair equipment.

**Coordinator:** Matt Grenoble, CM, Operations Supervisor,  
Waukesha County Airport

**4:30 p.m. – 6:00 p.m.**

**Reception with Exhibitors and Sponsors**

**Country Springs Hotel Exhibit Hall**

*Sponsored by: MSA Professional Services, Inc.*

**5:30 p.m. – 6:00 p.m.**

**Transportation to Waukesha County Airport / Crites Field –**

**Welcome Reception & Dinner**

Meet in the lobby.

**6:00 p.m. – 9:00 p.m.**

**Welcome Reception & Dinner**

**Waukesha County Airport/Crites Field**

Comments by: Kurt Stanich, President, WAMA

*Sponsored by: Atlantic Aviation*

**8:00 p.m. – 9:30 p.m.**

**Transportation to Country Springs Hotel**

*Sponsored by: Shell Aviation & Eastern Aviation Fuels*

# Aviation Award Past Recipients

## Lifetime Service Award

1981	Robert Skuldt
1982	Libby Parod
1983	Fritz Wolf
1984	Bob White
1985	Carl Rindlisbacher
1986	Charles Wood
1987	Harry Chaplin
1988	Carl Guell
1989	Paul Poberezny
1990	Phil Leyda
1991	Earl Pingel
1992	Walter Mayo
1993	Howard Morey
1994	Robert Acker
1995	Warren Basler
1996	Field Morey
1997	Duane E. Esse
1998	Harold (Duffy) Gaier
1999	Mary Millard
2000	William H. Green
2001	Doug Bake
2002	Not Awarded
2003	Robert Kunkel
2004	Robert G. Heck
2005	Thom Thomas
2006	James Hansford
2007	Bob Egan
2008	Peter Drahn
2009	Lee Perrizo
2010	C. Barry Bateman
2011	Ton Sneig
2012	Dan Wruck
2013	Jerry Stites
2014	Joseph Brauer
2015	Don Winkler
2016	Tony Yaron

## Airport Engineering Award

1983	Thomas Janssen
1984	Joe Abernathy
1985	Leo Bussan
1986	Al Fawley
1987	Bill Green
1988	James Foley
1989	Dave Dyrstad
1990	Keith Lindsley
1991	Mike Hinz
1992	Leroy Gilhausen
1993	Andrew Platz
1994	Roy Eckrose
1995	Mike Kirchner
1996	Phil Ramlet
1997	Roy Gilhausen
1998	David Elder
1999	Boyd Schleicher
2000	David Phillips
2001	Tom Janssen, Jr.
2002	Not Awarded
2003	Bryan Page
2004	Wendy Hottenstein
2005	Aaron Stewart
2006	Randy Van Natta, Kevin Lang
2007	Kevin Sielaff
2008	Lisa Kinsman
2009	Laura Morland
2010	Mark Porlier
2011	Ed Baisch
2012	Greg Stern
2013	Jim Zsebe
2014	Christopher Reis
2015	Steve Opatik
2016	Marcus Kuhn

**Wisconsin Concrete Pavement Association****Booth #7**

The Wisconsin Concrete Pavement Association (WCPA) is the statewide professional association of the concrete pavement industry. Since 1952, WCPA has been committed to representing the interests of our members by promoting the benefits of concrete pavement by providing a resource for education and research, developing new markets and technology, and fostering a membership dedicated to building meaningful public and private partnerships for the purpose of promoting the use of concrete pavement as the best pavement value.

**Wisconsin Aviation Hall of Fame****Booth #4**

The Wisconsin Aviation Hall of Fame is a non-profit membership organization dedicated to preserving the past and fostering the future of flight in Wisconsin and beyond our borders. Our mission is to collect and preserve the history of aviation in Wisconsin, recognize those who made it, inform others of it, and promote aviation education for future generations.

**Wittman Regional Airport**

Wittman Regional Airport is a county-owned public use airport located two miles south of the central business district of Oshkosh, a city in Winnebago County, Wisconsin, United States. The airport was named after pioneer air racer and aircraft designer and builder Steve Wittman in 1972. Originally named Winnebago County Airport, it is home to EAA and EAA AirVenture.

**World Fuel Services****Booth #29**

World Fuel Services provides comprehensive flight operation solutions that include contract fuel, trip support services, AVCARD<sup>®</sup> aviation charge card, aviation insurance, and the FlyBuys<sup>™</sup> Rewards Program. More than 8,200 flight departments trust World Fuel Services to deliver high-quality service to over 20,000 aircraft around the world. World Fuel Services provides solutions to airports & FBOs that encompass branded and unbranded fuel supply, World Fuel Services Network FBO programs, and the Air Elite<sup>®</sup> Network of Diamond Service FBOs. With more supply locations than any other Business & General Aviation supplier, they provide more than 7 billion gallons of fuel annually to airports of all sizes.

# ***Tuesday, April 25***

**7:00 a.m. – 8:45 a.m.**

**Grand Salon**

**Breakfast with the Exhibitors**

***Sponsored by: Short Elliott Hendrickson, Inc. (SEH)***

**8:00 a.m. – 9:00 a.m.**

**Association Board Meetings (WAMA & WBAA)**

WAMA Meeting

Executive Board Room

WBAA Meeting

Conference Room 2

**9:00 a.m. – 9:15 a.m.**

**Grand Salon**

**Official Conference Opening & Welcome**

***Sponsored by: Waukesha County Airport***

**9:15 a.m. – 10:30 a.m.**

**Grand Salon**

**General Session I**

**Aviation Issues Panel Discussion**

Stimulating conversation by and between industry leaders on the issues facing airports, FBOs, pilots, and other industry stakeholders.

**Panelists:** David Greene, Director, Wisconsin Bureau of Aeronautics  
Scott Brummond, Aeronautical and Technical Service Chief,  
Wisconsin Bureau of Aeronautics  
Tom DeWinter, PE, Airport Construction Standards Chief,  
Wisconsin Bureau of Aeronautics  
Matt Malicki, Airport Engineering Section Chief,  
Wisconsin Bureau of Aeronautics

**Coordinators/Moderators:**

Abe Weber, CM, Airport Director, Appleton International Airport

Kurt Stanich, Airport Director, Waukesha County Airport

***Sponsored by:***

***Leibowitz & Horton Airport Management Consultants, Inc.***

**10:30 a.m. – 11:00 a.m.**  
**Coffee Break with Exhibitors**

**Exhibit Hall/Grand Salon**

***Sponsored by: Wisconsin Business Aircraft Association (WBAA)***

**11:00 a.m. – 4:00 p.m.**

**One – on – One “Speed Dating” between Airports and the Chicago Airports District Office**

This is your opportunity as an airport sponsor to meet face-to-face with representatives of the Chicago Airports District Office (ADO) about issues specific to YOUR Airport.

**FAA Program Managers:** Mike Ferry, Executive Learning Center 1  
Rob Lee, Executive Learning Center 4

***Sponsored by: Wisconsin Airport Management Association (WAMA)***

**11:00 a.m. – 12:00 p.m.**

**Grand Ballroom**

**General Session II**

**Drones/UAVs and FAR Part 107**

UAVs continue to evolve in their application and regulatory framework. See the latest trends in UAV applications, how the new Part 107 is being applied, and how UAVs impact operations at airports. UAVs continue to evolve in their abilities and functions and will become a common day occurrence around airports throughout the world. The new FAR Part 107 sets the initial regulatory framework for how UAV operators will be integrated into the NAS and how they will interact with airports and air traffic in the US. Finally, new technology is being explored for airports and national security purposes; we will briefly explore these new upcoming technologies.

**Speakers:** Kevin Morris, FAASTeam Program Manager, Operations, Minneapolis FSDO  
Jason Gillett, CM, ACE, Assistant Airport Director, La Crosse Regional Airport

**Coordinator/Moderator:**

Clint Torp, CM, Airport Director, La Crosse Regional Airport

***Sponsored by: M-B Companies, Inc.***

**12:00 p.m. – 1:00 p.m.**

**Grand Salon**

**Lunch**

***Sponsored by: TKDA***

***SP+ Airport Services  
Wisconsin Aviation***

**The Green Earth Deicer Company, Inc.****Booth #17**

We are the Wisconsin distributor for Cryotech, the manufacturer of Runway Deicers. We also supply environmentally friendly deicers for sidewalks, surface parking lots, parking structures.

**Waukesha County Airport**

Waukesha County International Airport, also known as Greater Milwaukee Airport, is a public use airport located two miles north of the central business district of Waukesha, a city in Waukesha County, Wisconsin. It is owned and operated by Waukesha County. In 2008, Flight for Life-Wisconsin moved its operations to this airport.

**Waukesha – Pewaukee Convention & Visitor's Bureau**

The Waukesha Pewaukee Convention and Visitor Bureau (WPCVB) is an economic development organization that attracts overnight visitors in the convention, leisure and sports markets through sales, marketing and destination development.

**Westmor Fluid Solutions****Booth #1**

Aviation Fueling systems including: Aviation Refuelers, Bowsers, Hydrant Carts, Fueling Cabinets & Ladders, Mobile Fuel Testing, Bulk Storage and Equipment Service.

**Wisconsin Business Aircraft Association**

WBAA's purpose is to promote, improve and advance the interests of business aviation, aviation infra-structure, safety and public education, to take such steps as are proper and necessary to better relations and secure proper advantages from regulatory and other agencies, and by these means to attain wider recognition of the fact that business aviation is of primary importance to the economy of the State of Wisconsin.



## **SP+ Airport Services**

SP+ Airport Services focuses exclusively on the airport sector. Our multi-disciplined team of experts understands the unique demands of the airport operating environment, delivering customized solutions designed around the conditions and needs of each individual facility. Having first introduced the concept of paid airport parking in 1951, SP+ has over 60 years of experience in airport operations managing parking, shuttle service, ground transportation, valet, curbside management and related landside services for airports of all sizes nationwide.

## **TKDA**

TKDA is a 100-percent employee-owned engineering, architecture, and planning firm that was established in 1910. As a multi-discipline firm, TKDA is able to seamlessly and successfully provide comprehensive, award-winning services to communities, public agencies, and private industry. TKDA is dedicated to providing exceptional service to our aviation clients across the U.S. with a staff solely committed to aviation planning, design, and construction engineering services.

## **T.E. Brennan Company**

T.E. Brennan Company provides impartial, independent risk management and insurance advice to our clients in property/casualty and employee benefits. We do not sell insurance. We are not affiliated with, nor do we work for, any agent, broker or insurance company. Frustrated with what's going on in your world of risk management? Seeking impartial options? Contact us for a free consultation. Find out how the "TEB Factor" can work for you!

## **Thales**

## **Booth #19**

For more than 80 years, Thales has been a major supplier of leading edge navigation and surveillance solutions for the U.S. Federal Aviation Administration, the Department of Defense, and directly to airports around the world. Through innovation and customer partnership, our air traffic management solutions now span navigation, automation, communication and surveillance, helping the aviation community meet their needs for increased safety, capacity and efficiency. For more information, please visit us at [thalesgroup.com/USA/ATM](http://thalesgroup.com/USA/ATM)

## **Concurrent Professional Sessions**

**1:00 p.m. – 2:00 p.m.**

**Woodfield A-B**

### **TALPA (Takeoff and Landing Performance Assessment) – What We've Learned**

Changes and improvements in reporting runway conditions, particularly during winter operations, have brought many questions from airport operators, pilots, and ATC operations. Following a season of using the new system, we can share information on the functionality of the news standards.

**Speakers:** Joshua Migdal, Air Safety Investigator, Delta Air Lines

Birke Rhodes, Manager, Safety Standards,  
FAA Great Lakes Region

Michael Stephens, Director of Operations & Public Safety,  
Dane County Regional Airport

Matt Grenoble, CM, Airport Operations Supervisor,  
Waukesha County Airport

#### **Coordinators/moderators:**

Peter Moll, Airport Director, Wittman Regional Airport

William LeGore, Director of Facilities & Maintenance,  
Dane County Regional Airport

*Sponsored by: HUB Parking Technology*

**1:00 p.m. – 2:00 p.m.**

**Woodfield C-D**

### **Justification and Eligibility: AIP Funding Challenges in the Modern World**

Capital improvements require significant financial investment and advance planning. Many projects are eligible for funding, but a second component – justification – is required to receive a grant. Learn how to develop sound justification for your upcoming projects and best position your upcoming projects to make them a reality.

**Speakers:** Paul Strege, PE, ME, Midwest Aviation Leader,

Mead & Hunt, Inc.

Rich Kuhl, M.P.A., Planning & Programming Branch Manager,  
FAA Great Lakes Region

**Coordinator/moderator:** Chris Reis, PE Aviation Engineering Manager,  
Mead & Hunt, Inc.

**2:00 p.m. – 2:30 p.m.**

**Exhibit Hall**

### **Refreshments with Exhibitors**

*Sponsored by: NewView Technologies, Inc.*

## Concurrent Professional Sessions

**2:30 p.m. – 3:20 p.m.**

**Woodfield A-B**

### **TSA & Airports – Commercial and General Aviation**

Discussions with Mark L. Lendvay, TSA Federal Security Director for the State of Wisconsin, and other agency leaders on current threats to aviation, the Transportation Security Administration's response, and what it means to Wisconsin airports. This will be a unique session that is tailored to both commercial service and general aviation airports.

**Speakers:** Mark Lendvay, TSA Federal Security Director for Wisconsin  
Matt Loppnow, TSA Field Intelligence Office  
Ed Rooney, TSA Assistant Federal Security Director,  
Law Enforcement  
Chris Marks, TSA Assistant Federal Security Director,  
Compliance

**Coordinator/moderator:** Brian Grefe, CM, Airport Director,  
Central Wisconsin Airport

***Sponsored by: ISG***

**2:30 p.m. – 3:20 p.m.**

**Woodfield C-D**

### **Airport Aeronautical & Non-Aeronautical Revenue Generation, and Leasing Issues**

Federal and State Funding may be on the decline.

**Discuss:** How can we finance airport related projects with dwindling government support? What creative or new ways can we, as airport operators, exercise to meet this issue? Are P3s (Private, Public, Partnerships) the new future? Do we already have versions of P3s operating in our airports today?

**Discuss:** How can airports of all sizes take advantage of private investments to support their operations. What are the political and operational challenges in the way? The "new" FAA Hangar Leasing guidance has changed what is allowed in your hangars.

**Discuss:** What are your rights as the airport operator, what can we still allow in our facilities and how will this new rule affect our tenants and operators.

**Speakers:** Michael Fetchko, Airport Properties Manager,  
General Mitchell International Airport

**Coordinator/moderator:** Ismael Bonilla, Airport Director,  
General Mitchell International Airport

***Sponsored by: Avfuel Corporation***

**Quantum Spatial, Inc.****Booth #3**

Quantum Spatial is an industry leader in FAA AC 150/5300 airport mapping solutions. We've mapped more than 475 airports under the latest FAA guidelines, including over 50 eALPS and the first eALP to be approved by the FAA. We offer technical excellence and superior service for all of your airport mapping needs.

**Shell Aviation / Eastern Aviation Fuels****Booth #6**

Eastern Aviation Fuels is the national marketer of Shell branded aviation fuels in the United States. Our longstanding supplier relationships provide our customers competitive pricing, dependable supply, and business-enhancing support programs. Above all, our customers receive service beyond compare.

**Sherwin Industries, Inc.**

Our fourth generation Wisconsin company (est. 1938) distributes airport runway support products, pavement maintenance products, FOD sweepers, airfield friction meters and airfield markings.

**Short Elliott Hendrickson, Inc. (SEH)****Booth #25**

Short Elliott Hendrickson Inc. (SEH<sup>®</sup>) is an employee-owned company of engineers, architects, planners, and scientists serving public and private sector clients. Our work – providing valuable solutions in the Aviation, Buildings, Energy, Environmental, Infrastructure, Transportation, and Water markets – is focused on Building a Better World for All of Us<sup>®</sup>.

**Signature Flight Support**

Relentlessly customer-centric, Signature Flight Support is an international company focused on providing the aviation industry with a wide range of services and products. This is accomplished through a network of highly qualified, motivated and consistently trained employees who are committed to the Signature vision, mission and values.

**Mead & Hunt, Inc.****Booth #5**

Mead & Hunt is an employee-owned firm with more than 500 engineers, architects, scientists, planners and support staff in offices nationwide. We have been serving clients in both the public and private sectors since our founding in 1900. Mead & Hunt is one of the fastest growing architectural, engineering and planning firms in the nation. For several consecutive years, Engineering News Record has ranked Mead & Hunt as a top 500 A/E design firm and a "Top 25 in Airports" firm. In addition, Mead & Hunt received the prestigious American Association of Airport Executives' Corporate Cup of Excellence award. We were also ranked in the top 10 "Best civil engineering firms to work for" in the nation by CE News magazine.

**NewView Technologies, Inc.**

NewView Technologies, Inc. was founded in 1996, and specializes in repairing aircraft windows, including private, corporate and air carrier aircraft.

**OMNNI Associates****Booth #31**

For 30 years, OMNNI has provided planning, engineering and construction administration services to commercial and general aviation airports throughout Wisconsin. Projects have involved both airside and landside improvements and expansions, many of which have won state and national awards for engineering excellence.

**Oshkosh Airport Products, LLC****Booth #12**

Proud manufacturers of heavy-duty all-wheel drive ARFF trucks as well as snow removal trucks, plows, blowers and equipment.

**Planeskate****Booth #21**

Planeskate designs and manufactures equipment to safely move disabled aircraft.

**Platinum Flight Center**

Visit Platinum Flight Center in Appleton, Wisconsin and experience why we are the choice FBO in the Midwest. We take pride in our prompt and friendly service while recognizing that safety, flexibility, value, and comfort are extremely important. Whether you are here for business or leisure, we offer platinum standards from the moment you land until you are cleared for take-off. When it comes to relying on your aircraft's care, you can rest assured that you are in good hands.

## **Concurrent Professional Sessions**

**3:30 p.m. – 4:20 p.m.**

**Woodfield A-B**

### **Safety Management Systems (SMS) – The Dynamic Relationship of Airport Management, Pilots, and an SMS**

Join us along with Stacey Justesen, SMS Manager for California's Truckee Tahoe airport in a discussion of what the future holds for Airport (small to large) SMS structures.

**Speakers:** Gary Grass, Convergent Performance Solutions, Inc.  
Doug Downey, Convergent Performance Solutions, Inc.

**Coordinator/Moderator:** Kurt Stanich, Airport Director,  
Waukesha County Airport

***Sponsored by: Flyer 411***

**3:30 p.m. – 4:20 p.m.**

**Woodfield C-D**

### **Runway Incursion Prevention**

Join us for a discussion of the Runway Safety Area (RSA) Program and the new Runway Incursion Mitigation (RIM) Program. The RIM program builds on the legacy of the RSA Program, which ended in 2015, by making additional runway safety improvement. Find out what defines a runway incursion, common causes of incursions, ways to reduce or eliminate incursions, what the RSA Program accomplished, and what we can expect from the new RIM Program.

**Speakers:** Don Rowlett, CM, ACE, Air Traffic Manager,  
Central Wisconsin Airport FCT  
Birke Rhodes, Manager, Safety Standards,  
FAA Great Lakes Region

**Coordinator/Moderator:**

Marty Piette, A.A.E., Assistant Airport Director,  
Green Bay Austin Straubel International Airport

***Sponsored by: Cooper Engineering Company, Inc.***

**4:00 p.m. – 5:30 p.m.**  
**WATA Annual Membership Meeting**

**Executive Board Room**

**4:30 p.m. – 6:00 p.m.**  
**Reception with Exhibitors**  
*Sponsored by: Signature Flight Group*

**Exhibit Hall / Grand Ballroom**

**6:00 p.m. – 8:00 p.m.**  
**Annual Awards Banquet**  
*Sponsored by: Mead & Hunt, Inc.*

**Grand Salon**

**Award Presentations:**  
**WATA by Dave Weiman**  
**WAMA by Kurt Stanich**

**8:00 p.m. – 9:30 p.m.**  
**Dessert Reception & Refreshments**  
*Sponsored by: Wisconsin Dells CVB*

**Exhibit Hall/Grand Ballroom**

## **Leibowitz & Horton Airport Management Consultants**

With offices in Denver, Atlanta and Houston, Leibowitz & Horton AMC provides financial consulting services to more than 90 commercial service airports. Our experience includes financial planning, rates & charges, airline/tenant negotiations, financial feasibility studies, PFC and CFC implementations and FAA BCA and funding assistance.

## **M-B Companies, Inc.**

**Booth #8**

The M-B Companies' Airport Maintenance Products Division offers snow removal products for clearing and maintaining airport pavement, runways, and ramp areas. Products include snow removal chassis, front mount, mid mount and towed brooms, material spreaders, truck mounted plows and snow blowers, cupping ramp plows and snow blowers for front end loaders. The Attachment Division offers power brooms, plows and blower attachments for almost any make and model of tractors skid steers, and utility vehicles. The Municipal Service Vehicle can be equipped with summer or winter attachments for maintenance tasks around your airport facility. Leveraging more than 100 years of experience and expertise, M-B's family of Airport Maintenance Products are supported by the best service support team in the industry.

## **METCO**

**Booth #16**

METCO is a long-established, single-source petroleum contractor for the installation, service and environmental consulting of all types of fuel system applications. Our primary customers include retail gas stations, municipalities and government institutions that maintain vehicle fleets, and industrial facilities that utilize tank systems for backup generator and boiler systems. We serve the tri-state area of Wisconsin, Minnesota and Iowa, and are dedicated to living up to our standard of "Excellence through experience."

## **MSA Professional Services**

**Booth #14**

MSA Professional Services helps pull all the complex pieces of your airport development project together. MSA provides comprehensive services in airport planning, environmental, design and construction engineering, architectural, electrical and land acquisition services. Let us become your trusted partner in airport development.



### **HUB Parking Technology USA, Inc.**

HUB Parking Technology develops, manufactures, installs, and provides after-sales services for PARC Systems branded ZEAG and DATAPARK in the United States. Our innovative products, cutting edge software and mobile solutions serve a wide variety of applications. These sophisticated, total system solutions and services will improve your business performance. As a vertically integrated company controlling everything from design and manufacturing to installation, maintenance and support, we are positioned to achieve lower total cost of ownership for our clients. Our airport client base is quite extensive from small and medium sized regional airports to large, international airports such as LAX and MSP. Visit our website [www.hubparking.us](http://www.hubparking.us) for more information.

### **Hinshaw & Culbertson LLP**

Hinshaw is a national law firm with approximately 500 lawyers. We offer a full-service practice, with an emphasis in litigation, corporate and business law, environmental, labor and employment law, professional liability defense, and wealth preservation and taxation matters. Our attorneys provide services to a range of for-profit and not-for-profit clients in industries that include construction, financial services, health care, insurance, legal, manufacturing, real estate, retail and transportation. Our clients also include government agencies, municipalities and schools.

### **Interstate Sealant & Concrete, Inc. (ISC)**

**Booth #24**

ISC is a Pavement Maintenance Contractor that specializes in joint and crack sealing, concrete spall repair and replacement as well as cross-stitching and full-depth expansion joint repair nationwide using a variety of applications and materials to increase the longevity of the pavement.

### **ISG**

ISG has a rich history, that extends over 40 years, of building trusting relationships with clients, stakeholders, and the community. As a multi-disciplinary firm that is 100% owned by employees, ISG serves numerous markets and clients nationwide. With 8 offices in 3 states, ISG's local aviation experience is backed by a group of creative and resourceful engineers, environmental scientists, and designers that put real world experience to work.

# ***Wednesday, April 26***

**8:00 a.m. – 10:00 a.m.**

**Grand Salon**

**Breakfast/General Session**

**The Pilot Supply Issue and Other Air Service Challenges**

Join us for a panel discussion on the pilot shortage and other air service challenges. William Swelbar, *InterVISTAS Consulting LLC*, will cover the issues for airports surrounding the pilot shortage and what a new organization called the Regional Air Service Alliance (RASA) is doing to address these issues. President of the Regional Airline Association (RAA), Faye Malarkey Black, will discuss the pilot shortage from the regional airline perspective and what the RAA is doing/proposing to combat the pilot supply issue.

**Speakers:** William Swelbar, Executive Vice President,  
InterVISTAS Consulting, LLC

Faye Malarkey Black, President, Regional Airline Association

**Coordinator/moderator:** Charity Zich, CM, Airport Director,  
Chippewa Valley Regional Airport

**Sponsored by: Signature Flight Group**

**10:00 a.m. – 10:15 a.m.**

**Grand Salon**

**Conference Closing Comments**

Kurt Stanich, President, WAMA

Charles Sweet III, 2018 Conference Chair

**10:15 a.m.**

**Exhibitor Teardown**

**Exhibit Hall / Grand Ballroom**

***Sponsored by: Pewaukee/Waukesha Convention  
& Visitors Bureau***

## 2017 Wisconsin Aviation Conference Sponsors

Atlantic Aviation	Corporate Excellence
Mead & Hunt, Inc.	Corporate Excellence
Signature Flight Support Corp.	Corporate Excellence
Anonymous	Platinum
Bruce Municipal Equipment	Platinum
Leibowitz & Horton Airport Management Consultants	Platinum
Oshkosh Airport Products, LLC	Platinum
SP+ Airport Services	Platinum
Shell Aviation / Eastern Aviation Fuels	Platinum
Short Elliott Hendrickson	Platinum
TKDA	Platinum
Wittman Regional Airport	Platinum
Avfuel Corporation	Gold
Becher-Hoppe Associates, Inc.	Gold
Crawford, Murphy & Tilly, Inc.	Gold
First Class Concessions	Gold
HUB Parking Technology USA, Inc.	Gold
Hinshaw & Culbertson LLP	Gold
ISG	Gold
M-B Companies, Inc.	Gold
MSA Professional Services	Gold
NewView Technologies, Inc.	Gold
Platinum Flight Center	Gold
OMNII Associates, Inc.	Gold
Waukesha County Airport	Gold
Wisconsin Business Aircraft Association (WBAA)	Gold
Wisconsin Aviation	Gold
Aero Insurance, LLC	Silver
Applied Pavement Technology, Inc.	Silver
Cooper Engineering Company, Inc.	Silver
Flyer411	Silver
Sherwin Industries, Inc.	Silver
T.E. Brennan Company	Silver
Westmor Industries	Silver

**Ennis-Flint****Booth #28**

Achieve maximum value and optimal performance with AirMark durable airfield pavement markings. Engineered for use on taxiways, ramps, aprons, gates, and airside vehicle roadways, application advantages are pronounced in multi-colored markings typically labor intensive when using other marking materials. Included in AC 150/5370-10G, AirMark is designed to last 8-12 times longer than paint. Other airfield products include paint, epoxy, MMA, and coatings for "No Taxi" green islands.

**Erect-A-Tube****Booth #9**

We manufacture airplane hangars and hangar doors.

**Fahrner Asphalt Sealers LLC****Booth #10**

Fahrner Asphalt Sealers is a full-service asphalt maintenance company with over 35 years' experience. Crack sealing, chip sealing, line painting, infrared patching, hydro-blasting, and special services.

**First Class Concessions, Inc.**

First Class Concessions is just that, First Class. We strive to live up to our name in everything we do, from the menu items we present to the way we treat and appreciate our customers. We never lose sight of the fact that we represent our partner, the airports we serve, in everything we do.

**Flyer411**

Flyer411 places interactive digital signs in airport terminals and FBOs. These signs have aviation weather, community information and aviation related advertising. We place them at no charge. Please stop by our booth for more information and a demonstration.

**Gee Asphalt Systems, Inc.****Booth #2**

Gee Asphalt Systems specializes in Asphalt Preservation for airfield pavements both inside and outside of the fence. Specifically, we install ASTM 3405 hot applied crack and joint sealants, GSB-88<sup>®</sup> Sealer Binder high performance fog seal with micro friction agent (also known as P-608 Emulsified Asphalt Seal), and re-lining of runway markings. Coat. We are a family owned company and care about the quality of services we deliver to our clients and have successfully completed many aviation projects throughout the Midwest. Please visit our website [www.geeasphalt.com](http://www.geeasphalt.com) for more information.

## **Cooper Engineering**

Founded in 1950, Cooper Engineering of Rice Lake, Wisconsin, has grown into being a full-service civil and environmental engineering firm. Cooper's transportation group provides planning, design and construction services to WisDOT and several counties and municipalities including many airports. We pride ourselves in quality cost-effective service.

## **Crawford, Murphy & Tilly, Inc. (CMT)**

Crawford, Murphy & Tilly, Inc. (CMT) is a full-service consulting firm focused on four markets: aviation; highways and bridges; water resources; and civil and site services. CMT provides planning, design, and construction observation phase services on projects that range from simple to complex. Providing superior service requires that we provide a dynamic and equitable work environment where talented professionals will want to make their career. And with an employee retention rate above the industry average, our clients can entrust their projects to professionals who will be familiar with their needs.

## **DBT Transportation Services**

### **Booth #20**

DBT Transportation Services is a small family-owned start-up company whose principals are aviation professionals with over 75 years of Aviation and Service experience. DBT provides field maintenance services in North America for Automated Weather Observation System (AWOS) and Runway/Roadway Weather Information Systems (RWIS). The company has offices in Colorado, just outside Denver, where they build the AWOS system and provide full NADIN weather dissemination services into the National Airspace. The company tagline is "Doing Business Together" and is built on the belief that the customer is the focus of our business.

## **EPIC Fuels**

### **Booth #23**

EPIC Fuels is a global supplier of aviation fuels, supplies and services to airlines, air cargo operators, general and corporate aviation, Fixed Base Operators as well as government and military customers around the world. Our diverse fuel supply network of over 300-plus supply points utilizes major refineries and all modes of transport to securely deliver quality-tested fuel to meet the needs of global aviation.

**EXHIBITOR****BOOTH #**

ADB Safegate	30
Airport Cooperative Research Program	15
Airport Lighting Company	11
Arrow Energy, Inc.	22
Avfuel Corporation	26
Becher-Hoppe Associates, Inc.	18
Bruce Municipal Equipment	12
Century Fence Company	27
DBT Transportation Services	20
EPIC Fuels	23
Ennis-Flint	28
Erect-A-Tube, Inc.	9
Fahrner Asphalt Sealers LLC	10
Gee Asphalt Systems, Inc.	2
Interstate Sealant & Concrete, Inc.	24
M-B Companies, Inc.	8
METCO	16
MSA Professional Services	14
Mead & Hunt, Inc.	5
OMNNI Associates	31
Oshkosh Airport Products, LLC	12
Planeskate	21
Quantum Spatial, Inc.	3
Shell Aviation / Eastern Aviation Fuels	6
Short Elliott Hendrickson (SEH)	25
Thales ATM U.S.	19
The Green Earth Deicer Company, Inc.	17
Westmor Industries	1
Wisconsin Concrete Pavement Association	7
Wisconsin Hall of Fame	4
World Fuel Services	29

**ABD SAFEGATE****Booth #30**

ADB SAFEGATE is a leading provider of solutions that boost efficiency, improve safety, raise environmental sustainability and reduce operational costs for airports from approach to departure.

**Aero Insurance, LLC**

Aero Insurance LLC is a leading provider of aircraft insurance, airport and helipad insurance, and all types of insurance plans for aviation needs. Aero Insurance LLC recognizes that each client's aviation insurance needs are unique. We will help you *"Get Cleared for Take Off!"* with your insurance needs.

**Airport Cooperative Research Program (ACRP)****Booth #15**

ACRP is an industry-driven, applied research program that develops practical solutions to problems faced by airport operators. ACRP is managed by the Transportation Research Board and sponsored by FAA. ACRP's products include a series of research reports, guidebooks, and tools that can be downloaded for free at [www.trb.org/acrp](http://www.trb.org/acrp).

**Airport Lighting Company****Booth #11**

Airport Lighting, Guidance Signs and Approach Lighting Manufacturer.

**Applied Pavement Technology, Inc.**

Applied Pavement Technology, Inc. (APTech) is a full-service pavement engineering consulting firm that provides effective solutions for the design, evaluation, maintenance, and rehabilitation of roadway and airport pavements.

**Arrow Energy, Inc.****Booth #22**

Arrow Energy is an independent supplier of aviation fuels since 1989. Our distribution network has over 150 terminals nationwide serving FBO's, corporate flight departments, medical flights, specialty airlines and ag operators. Our FBO program features the "Phillips 66" brand supported by dozens of terminals through several refineries. We work with you to provide the energy that propels aviation.

**Atlantic Aviation - UES**

With over 60 FBOs across the country, it's our pleasure to serve you and your aircraft needs. Whether it be for business, commercial, cargo, or military, we've got you covered. At Atlantic, we take pride in our exceptional customer service, handling your every need - no matter how big or small.

**Avfuel Corporation****Booth #26**

Avfuel Corporation provides comprehensive and customized aviation solutions for thousands of diverse aviation customers worldwide. We offer domestic and international fuel, contract fuel, flight planning and trip support, pilot rewards, aviation insurance, refueling equipment, fuel quality assurance programs, storage systems, parts and supplies.

**Becher Hoppe Associates, Inc.****Booth #18**

Becher Hoppe provides a wide spectrum of professional services to government, business, and individuals from our headquarters in Central Wisconsin. We provide planning, design, and construction services for civil engineering projects that involve airports, highways, bridges, roadways, trails, water and wastewater treatment systems, municipal utilities, stormwater management, dams, solid waste facilities, and agricultural site development. Other services provided include real estate appraisal and acquisition, mapping, land planning, and land surveying.

**Bruce Municipal Equipment****Booth #12**

Bruce Equipment, located in Menomonee Falls, is a distributor of Oshkosh Corporation vehicles and EPOKE equipment for airports in the four-state area.

**Century Fence Company****Booth #27**

Century Fence Company serves customers in the fencing and pavement marking industries. After 100 years, we continue to have an unwavering commitment to provide quality materials and excellent installations.







# Grand Ballroom

31 -10' x 8' booths  
inside Grand Ballroom

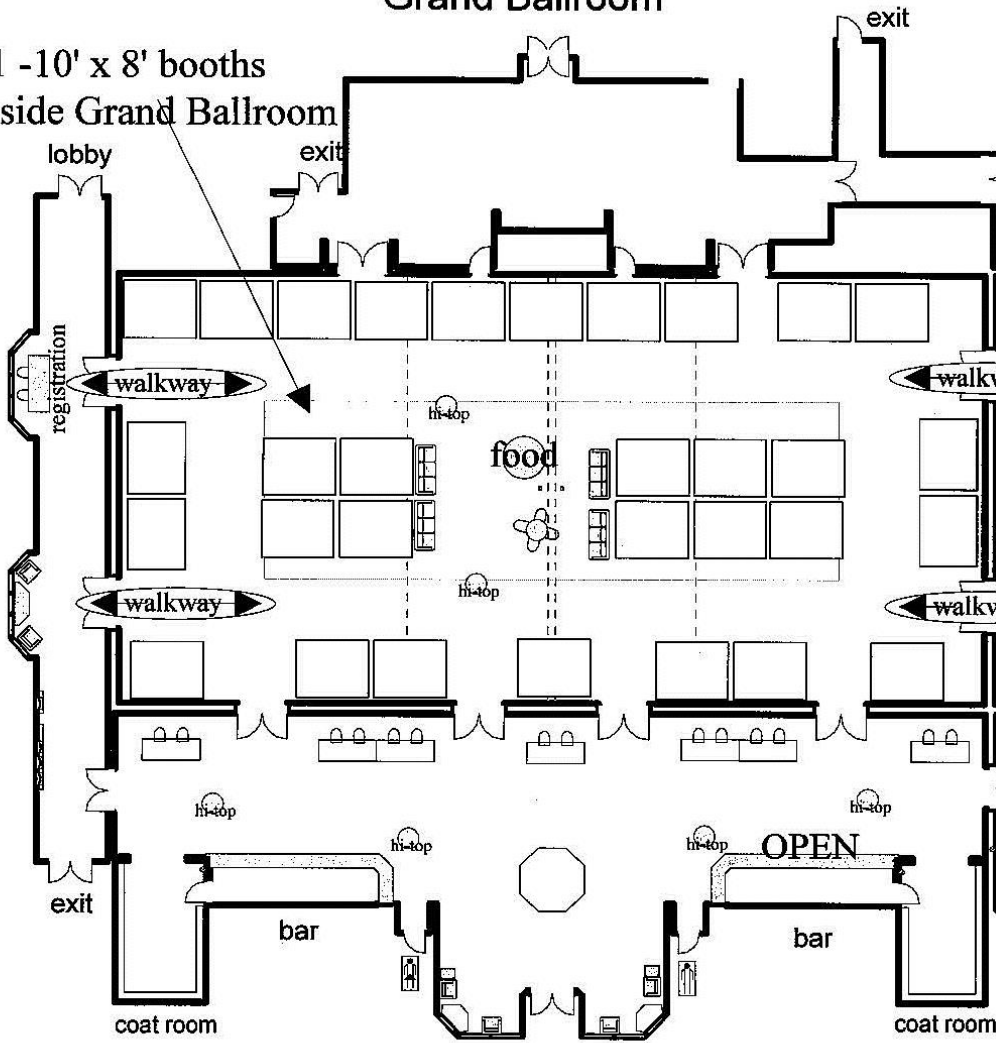

Grand Salon 30 - 72" Rounds  
with 10 people each  
exit

