



MKE Snow and Ice Control

Presented by: Airport Operations
and Airport Maintenance





FOX 8

RUNWAY SNOW REMOVAL

MKE Airport “Snow Flow”

- **Winter Operations Kick-Off**
- **Weather monitoring**
- **Notifications and staffing**
- **Coordination**
- **Preparation**
- **Plow Plans**
- **Documentation**
- **Post-Event and Post-Season**

Winter Operations Kick-Off

- **PowerPoint presentation for Ops and Maintenance before snow season**
 - **Last season statistics**
 - **This season's forecast**
 - **Safety reminders**
 - **Plow plans, sector maps, clearing priority map**
 - **Best business practices**
 - **Snow storage**
 - **Deice pads**



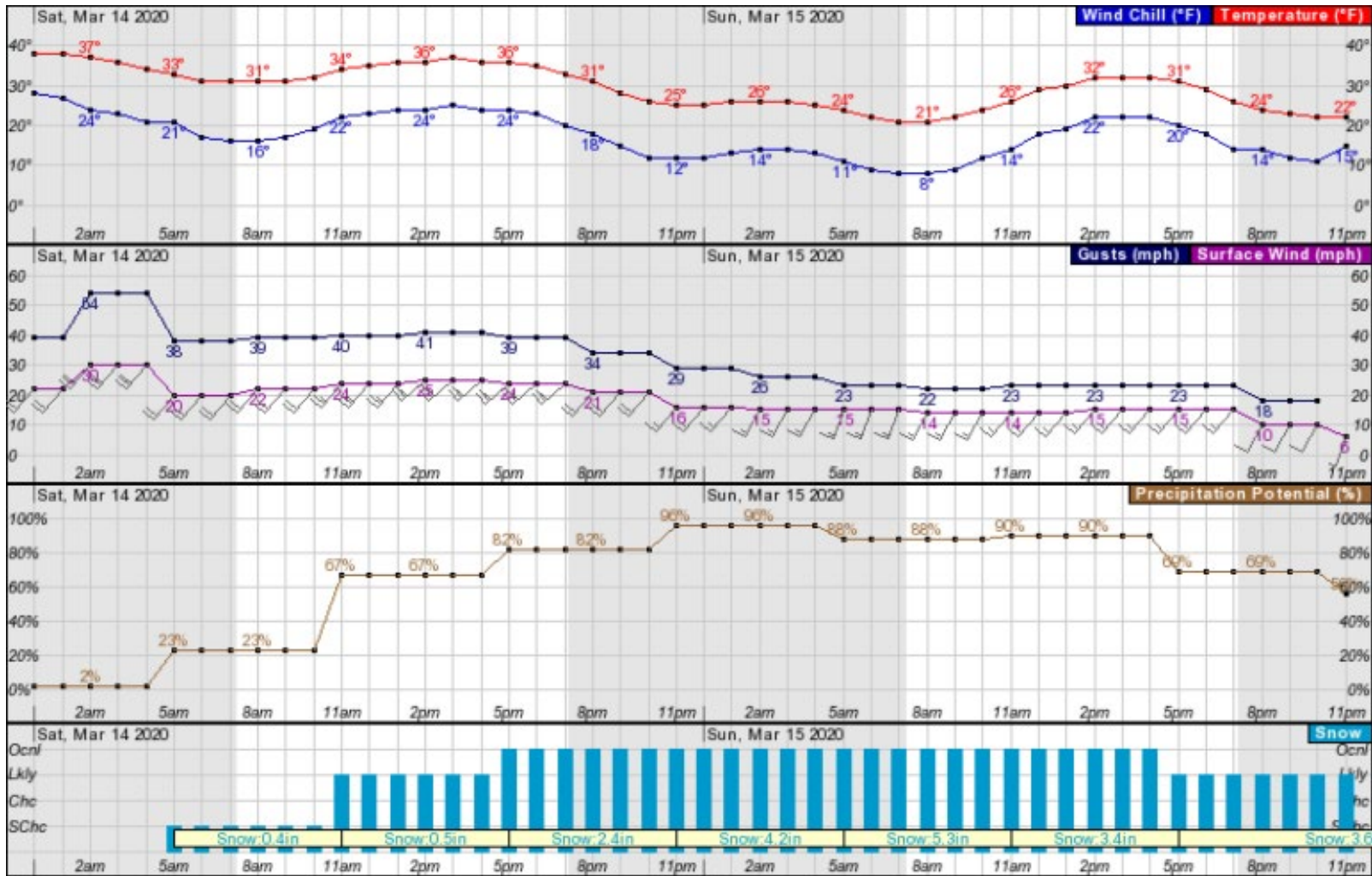

Weather Monitoring

Notifications and Staffing

- Everbridge
- MKE Communicator
- Ops and MX group chat
- Staff schedules
- Cityworks

SNOW ALERT

Enter / update incident details below

* 1 Snow Alert Level

Snow in the forecast



* 2 Weather Forecast

There is a chance of snow showers starting late afternoon tomorrow and continuing until early Sunday morning. With temperatures forecasted to be around freezing during this time period, snow start and end times may change. At this time no accumulating snow is forecasted. Winds being out of the south tomorrow afternoon will favor RWY 19R.

Please watch Communicator for the latest.

118 characters remaining

* 3 Anticipated Runway

19 RIGHT



Coordination

- Ops, Maintenance, and Tower communication
 - MKE Communicator

MKE Communicator Airside Terminal MKE Plans Security Maps/Charts Prefs Sys Admin Reports Logout 2155L 0255Z Internet HOME **PASSUR. AEROSPACE**

MKE Chat

1245L ebarnes BAGGAGE ALLEY BY ENVOY//AMERICAN PARTIALLY BLOCKED BY DISABLED BAG CART - PLEASE USE CAUTION

Airport Status **Runway Configuration** CLSD:07L-25R **Active NOTAMs**

MKE Airport is: OPEN
Airport Operations Supervisor on Duty: WHITT
Airside Operations Coordinator on Duty: CASPER
Landside Operations Coordinator on Duty:
Airport Operations: 414-747-5325 ops@mitchellairport.com
opssupervisors@mitchellairport.com
Sheriff: 414-747-5360
Sheriff Sgt On Duty:
Airport Fire: 414-747-5329
Fire Asst. Chief On Duty: CIESZYNSKI
Airport EOC is: CLOSED
Automated Weather: 414-489-2168
Airport Snow Desk is: CLOSED: 414-747-5325
Update #3 at 19Aug23 1931L/0031Z by ebarnes

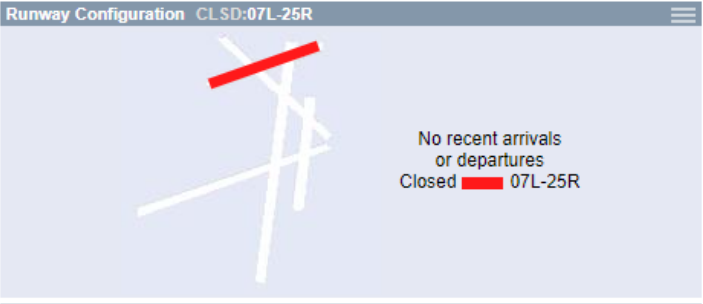

No recent arrivals or departures
Closed 07L-25R

Runways (RWY NOTAMs)
01L-19R

Active NOTAMs

Updated 20Aug 0130Z
!MKE 02/182 MKE TWY V CL MARKINGS BTN TWY E AND RWY 13/31 NOT STD 2302131034-2309012359
!MKE 03/095 MKE APRON TERMINAL RAMP AT GATE E61 WIP CONST LGTD AND BARRICADED 2303081221-2311302359
!MKE 03/357 MKE RWY 01R HLDG PSN SIGN AT RWY 13/31 S SIDE MISSING 2303201957-2312312359
!MKE 05/308 MKE RWY 01R/19L SFC MARKINGS FADED 2305241901-2310272359
!MKE 06/317 MKE APRON TERMINAL RAMP GATE D45 BTN TERMINAL AND VEHICLE ROADWAY IRREGULAR SFC STEEL PLATE 2306261435-2310312359
!MKE 06/318 MKE APRON TERMINAL RAMP GATE D48 BTN TERMINAL AND VEHICLE ROADWAY IRREGULAR SFC STEEL PLATE 2306261436-2310312359
!MKE 07/016 MKE TWY H NO ENTRY SIGN WEST SIDE BTN APCH END RWY 25R AND TWY K MISSING 2307051757-2310312359

AIN Status **Green**

Taxiways (TWY NOTAMs)

Coordination

- Airfield clearing priorities
- Preset staging locations for snow removal equipment

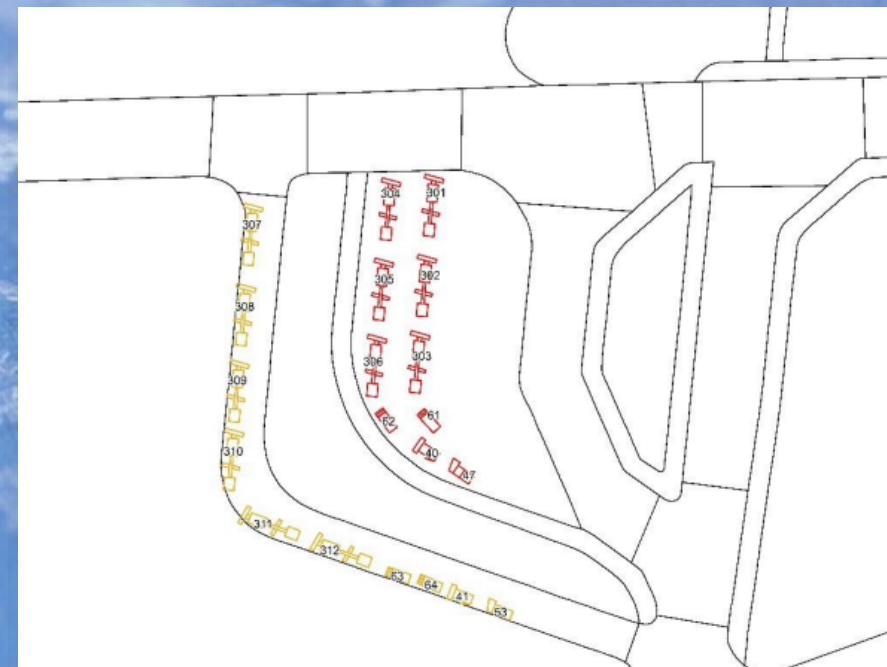
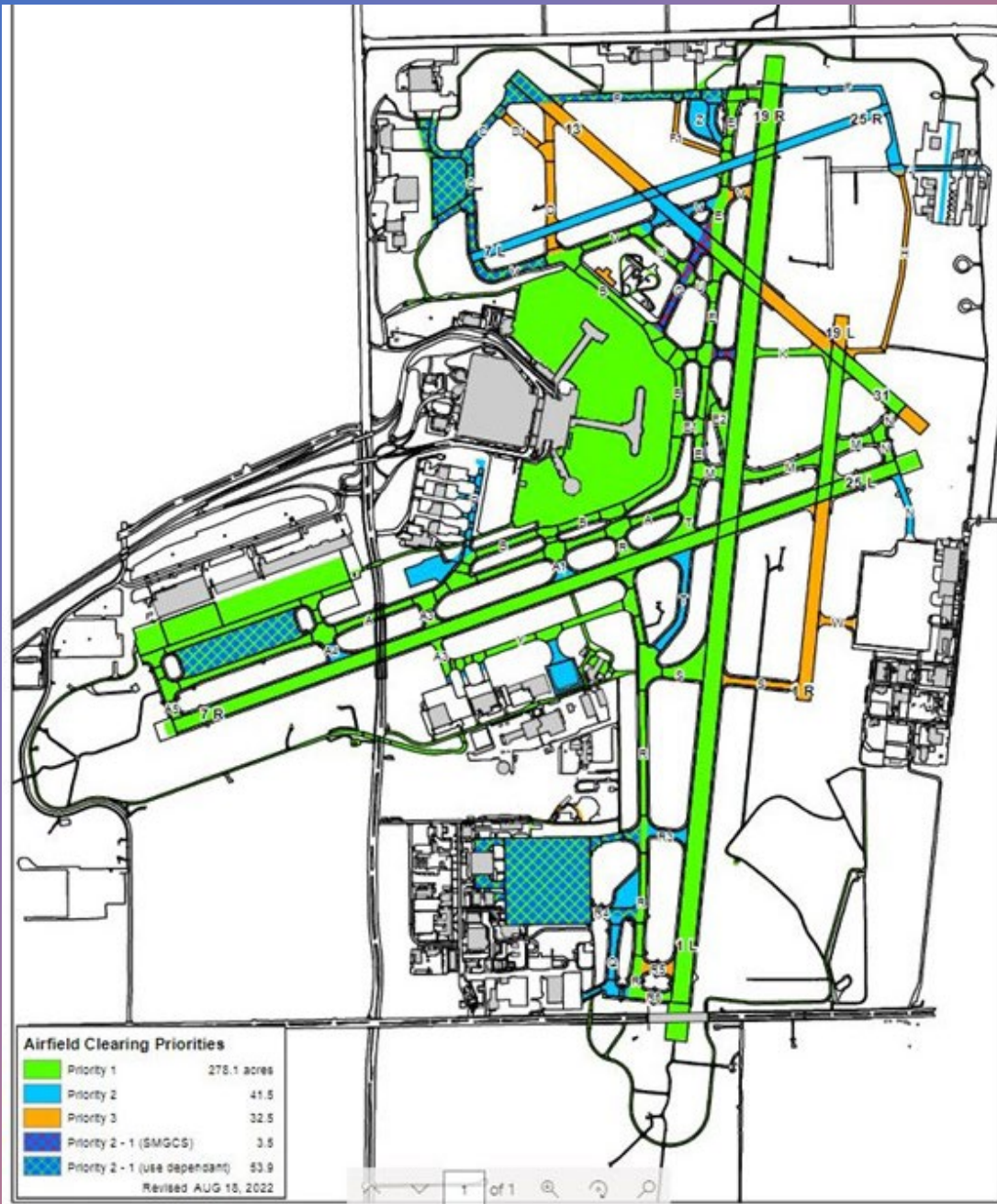

Preparation

- Closing runways not in use
- Pull snow removal equipment out of hangar, "blade up"
- Airlines choose deice pad

Plow Plans

- Plow plan for each runway direction
 - 1L, 19R, 7R, 25L
- Standard and alternate
- Delta variation and cargo variation
- Preset formation for snow removal equipment on runway

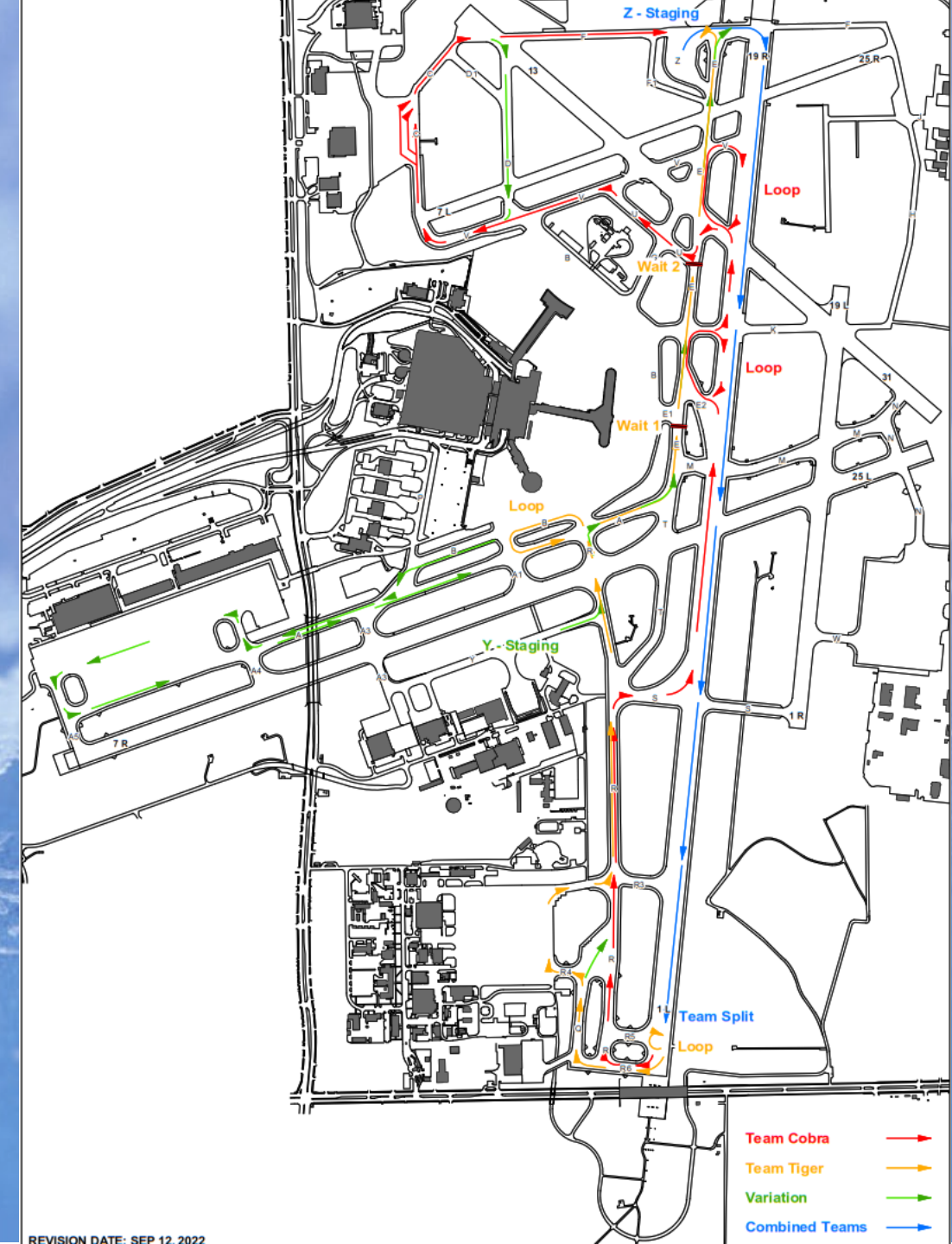
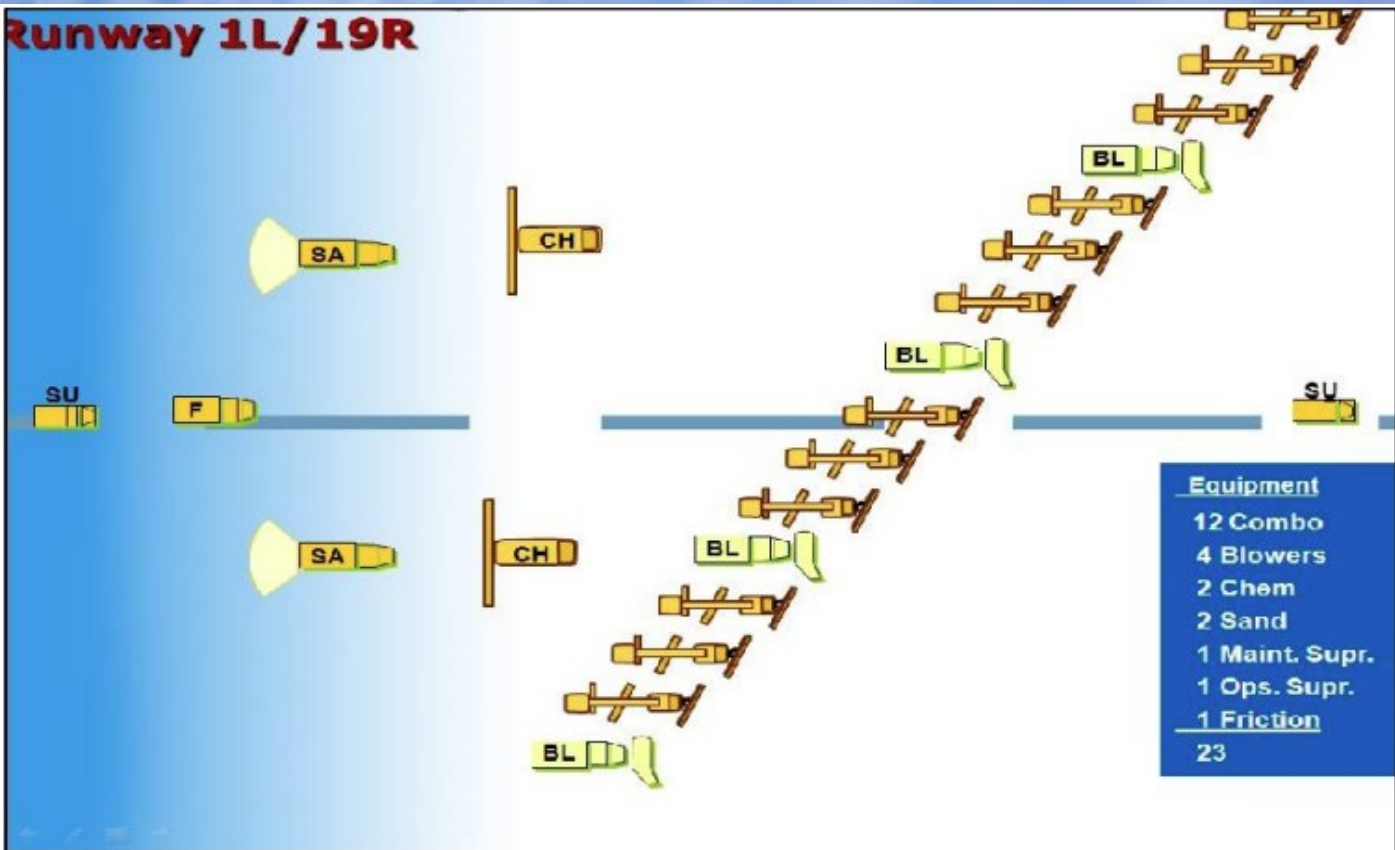

Documentation

OPERATIONS LOGBOOK ENTRY

Description: SNOW RUN

Request Id: 212912

Category: OPS LOG Priority: UNCLASSIFIED

Status: Closed

Initiated By: BERGINZ, PAUL Date: 2023-01-04 08:36 PM

Submit To: OPERATIONS

Project Name: Prj. Comp. Date:

Cancel? Date:

Cancel Reason: Canceled By:

Closed By: BERGINZ, PAUL Date: 1/4/2023 9:00:58 PM

Comments: Add Comment Sort

no comments

AIRCRAFT INVOLVED EVENT

Aircraft Info:

Airline/Company: 'N' Number:

Aircraft Make: Flight Number:

Aircraft Model: Origination:

Propulsion Type: Passengers: 0

Event Info:

Event Type: Runway:

Reason Location/Gate:

UnSuppressed:

JetBridge Used:

Heading: Wind Direction:

% Max Power: Wind Speed:

Event Start: Time:

Event End: Time:

Custom Fields

Category: SNOW RUN DATA

RWY IN USE	
DATE/TIME RWY CLOSED	2023-01-04 08:35 PM
PLAN USED	19R DEICING RUN
VARIATION	NONE
AIR TEMP	33.1
SURFACE TEMP	33.3
1ST LANDING PIREP	GOOD
AOC2	MC
RWY CC - TD	5
RWY CC - MP	5
RWY CC - RO	5
MU - TD	64
MU - MP	66
MU - RO	70
DATE/TIME RWY OPENED	2023-01-04 08:49 PM
EQUIPMENT OUTAGE	

INCIDENT INFORMATION

Details: RWY 19R FICON 5/5/5 100 PCT WET 150FT WID DEICED LIQUID

ASSOCIATED WORK

Work Orders

Group assets?

Link Existing WO:

Documentation



MKE SNOW EVENT RECORD January 4th – 5th, 2023 – Snow Event # 8

EVENT PLANNING

Forecast:

Today
A 30 percent chance of rain or drizzle, mainly after 5pm. Cloudy, with a high near 39. Southwest wind around 10 mph.

Tonight
A chance of rain and snow before 8pm, then a chance of snow. Cloudy, with a low around 30. Southwest wind around 10 mph. Chance of precipitation is 40%.

Thursday
A chance of snow before noon, then a chance of rain and snow between noon and 3pm, then a chance of rain after 3pm. Cloudy, with a high near 36. Southwest wind around 10 mph. Chance of precipitation is 50%.

Thursday Night
A 30 percent chance of snow showers before midnight. Mostly cloudy, with a low around 27. Northwest wind around 10 mph.

Everbridge Notification:

Snow Alert Level: Snow in the forecast

Weather Forecast: There is a chance of snow showers starting late afternoon tomorrow and continuing until early Sunday morning. With temperatures forecasted to be around freezing during this time period, snow start and end times may change. At this time no accumulating snow is forecasted. Winds being out of the south tomorrow afternoon will favor RWY 19R.

Please watch Communicator for the latest.

Anticipated Runway: 19 RIGHT

Alert Level	Snow Level 1
Anticipated Start Time	7 pm on Wednesday the 4 th
Tenant Notification Time	4 Jan 2023 @ 1506 local time
Anticipated Runway	19R, 25L
Anticipated Deice Pad	
Anticipated Mitigation Tactics	
Staffing Levels	Deice Crew
Staffing <u>call</u> out time	Jan 4: MX 3 rd in at 1930L Jan 5: 1 st until 1930L, 3 rd in at 1930L, full crew 2330L
Equipment Status	



MKE SNOW EVENT RECORD January 4th – 5th, 2023 – Snow Event # 8

ACTUAL EVENT

Actual Event Initiation	6:00PM Jan 4 2023
Precipitation Type	Snow showers
Precipitation Totals	.5 inch of new snow
Supplies Used:	
Sand / Sodium Acetate Mix	3 yards
Dry Chemical (Sodium Acetate)	
Liquid Chemical (Potassium Acetate)	6477 gallons
Equipment Status	
Event Termination	8:15am on Friday, January 6 th , 2023

NOTES

Drizzle consistent throughout afternoon.

Light snow showers from 6:00 PM to 6:40PM. Pavement temperatures sat around 33.3 degrees.

Deiced RWY 19R and associated routes at 8:35PM. Pavement temps still at 33.3.

On and off snow showers throughout the evening and early morning. Some slickness on non-treated areas, but treated areas yielded good braking action.

NWS added .1-inch accumulation for Jan 5 between 6PM and 11PM. Slight chance with no accumulation in forecast until Jan 6 at 3AM.

There was no snow clean up on previously untreated surfaces. By 1pm all snow was melting, and pavement was drying out.

CRITIQUES

Documentation



MKE SNOW EVENT RECORD January 4th – 5th, 2023 – Snow Event # 8

SNOW METRICS

MKE - SNOW PLOW RUN Report

1/3/2023 to 1/5/2023



Log#	RWY	Date/Time Closed	Plan used	Variation	Temps		1st PIREP	AOC2	RWY CC			MU			Date/Time Opened	Minutes Closed
					Air	Srfe			TD	MP	RO	TD	MP	RO		
212912	19R	1/4/2023 8:35:00 PM	19R DEICING RUN	NONE	33.1	33.3	GOOD	MC	5	5	5	54	55	70	1/4/2023 8:49:00 PM	14

Conditions: RWY 19R FICON 5/5/5 100 PCT WET 150FT WID DEICED LIQUID

Average Time of Closure (minutes): 14.00

Summary totals for Snow Runs

19R : (0)	1L : (0)	25L : (0)	7R : (0)
19R ALTERNATE : (0)	1L ALTERNATE : (0)	25L ALTERNATE : (0)	7R ALTERNATE : (0)
19R DEICING RUN : (1)	1L DEICING RUN : (0)	25L DEICING RUN : (0)	7R DEICING RUN : (0)
Totals: 19R: 1	1L: 0	25L: 0	7R: 0



MKE SNOW EVENT RECORD January 4th – 5th, 2023 – Snow Event # 8

COMMUNICATOR CHAT LOG

2023 Jan 04 11:59:46	slanghart	Snow Alert Level 1 issued. Please see the important airport information tab below for more information.
2023 Jan 04 18:27:29	abuczkowski	RWY 01R/19L / RWY 07L/25R / RWY 13/31 CLOSED
2023 Jan 04 18:49:50	abuczkowski	RWY 25L FICON 5/5/5 100 PCT WET
2023 Jan 04 18:50:37	abuczkowski	RWY 19R FICON 5/5/5 100 PCT WET
2023 Jan 04 19:57:43	abuczkowski	DEICE RUN FOR RWY 19R IN APPROX 30 MINUTES
2023 Jan 04 20:01:04	abuczkowski	RWY 7R/25L CLOSED
2023 Jan 04 20:36:52	abuczkowski	RWY 19R CLOSED DUEDEICE RUNE
2023 Jan 04 20:36:53	abuczkowski	RUN
2023 Jan 04 20:49:59	pberginz	RWY 1L/19R OPEN
2023 Jan 04 20:51:58	pberginz	RWY 19R FICON 5/5/5 100 PCT WET 150FT WID DEICED LIQUID
2023 Jan 04 21:01:18	abuczkowski	RWY 19R / BRAG / B737-8
2023 Jan 05 01:45:57	ebarnes	TWY P CLSD
2023 Jan 05 02:58:53	ebarnes	RWY 19R FICON 5/5/5 100 PCT WET DEICED LIQUID 150FT
2023 Jan 05 05:16:10	ecyprian	RWY 19R FICON 5/5/5 100 PCT WET DEICED LIQUID 150FT WID
2023 Jan 05 08:18:59	ebarnes	RWY 19R FICON 5/5/5 80 PCT WET DEICED LIQUID 150FT WID REMAINDER 1/8IN WET SN
2023 Jan 05 07:07:07	julrich	RWY 19R FICON 5/5/5 20 PCT 1/8IN WET SN AND 80 PCT WET DEICED LIQUID 150FT WID OBS AT 2301051305
2023 Jan 05 07:58:05	jgrava	BRA-G RWY 19R SHORTS 360
2023 Jan 05 08:12:35	julrich	BRA-G CEESNA 650 RWY 19R
2023 Jan 05 08:39:47	julrich	BRA-G CRJ900 RWY 19R
2023 Jan 05 08:50:30	julrich	RWY 25L open FICON 5/5/5 10 PCT 1/8IN WET SN AND 90 PCT WET DEICED LIQUID OBS AT 2301051449
2023 Jan 05 08:59:19	julrich	BRA-G A300 RWY 19R
2023 Jan 05 09:08:50	julrich	RWY 19R FICON 5/5/5 20 PCT 1/8IN WET SN AND 80 PCT WET DEICED LIQUID 150FT WID OBS AT 2301051506

Post-Event

- Clean-up / Sector work
- Wrap up Snow Event Report
- Bi-weekly snow meeting

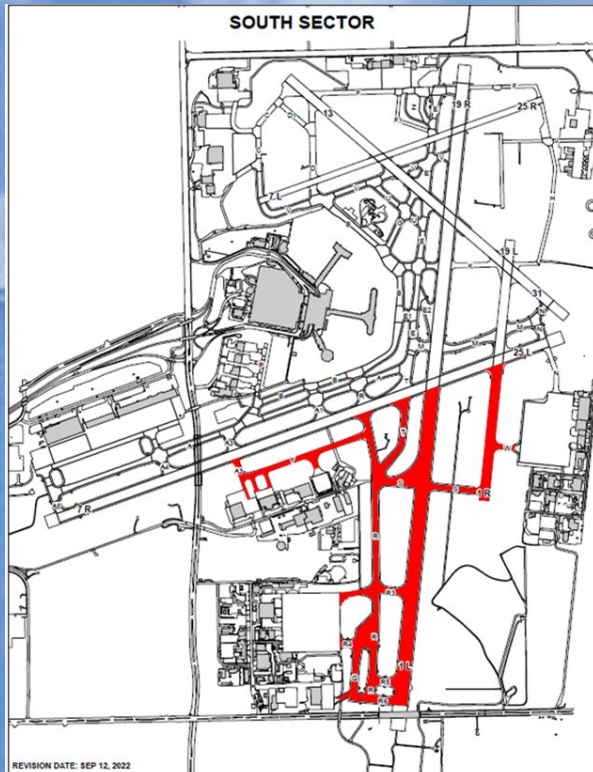

Post-Season

- Snow Season Wrap Up
 - PowerPoint presentation for Ops and Maintenance
 - Goals achieved
 - Statistics
 - Snow events
 - Critiques
 - Next year goals for improvement
 - Grill out