



Recent Activities & Accomplishments

RAF Director Jeff Russell





RAF Mission

The Recreational Aviation Foundation preserves, improves,
and creates airstrips for recreational access.



The RAF at 20 Years

2023

- Active in 50 States
- 12,000+ Supporters
- 501c3
- Enthusiastic & Committed
- Dedicated volunteers
- Clear vision for the future and a plan

12,000+
Supporters
Across
the USA

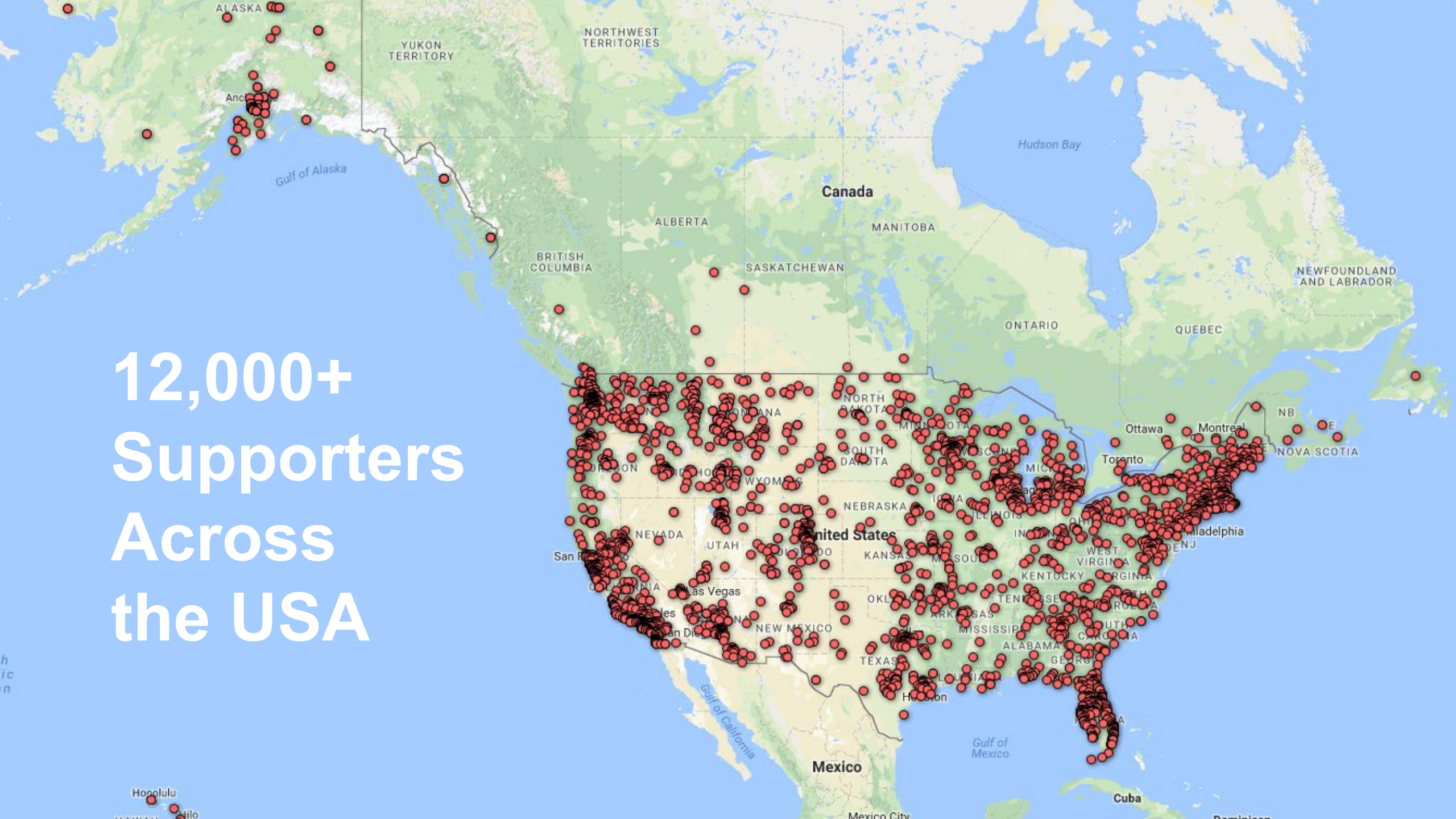

Working with Public and Private Partners



Airfield **Guide**





20 YEARS OF PROJECTS

- Airstrip the RAF has had a direct impact on
- Aviation language in state Recreational Use Statute

The Recreational Aviation Foundation preserves, improves, and creates airstrips for recreational access.

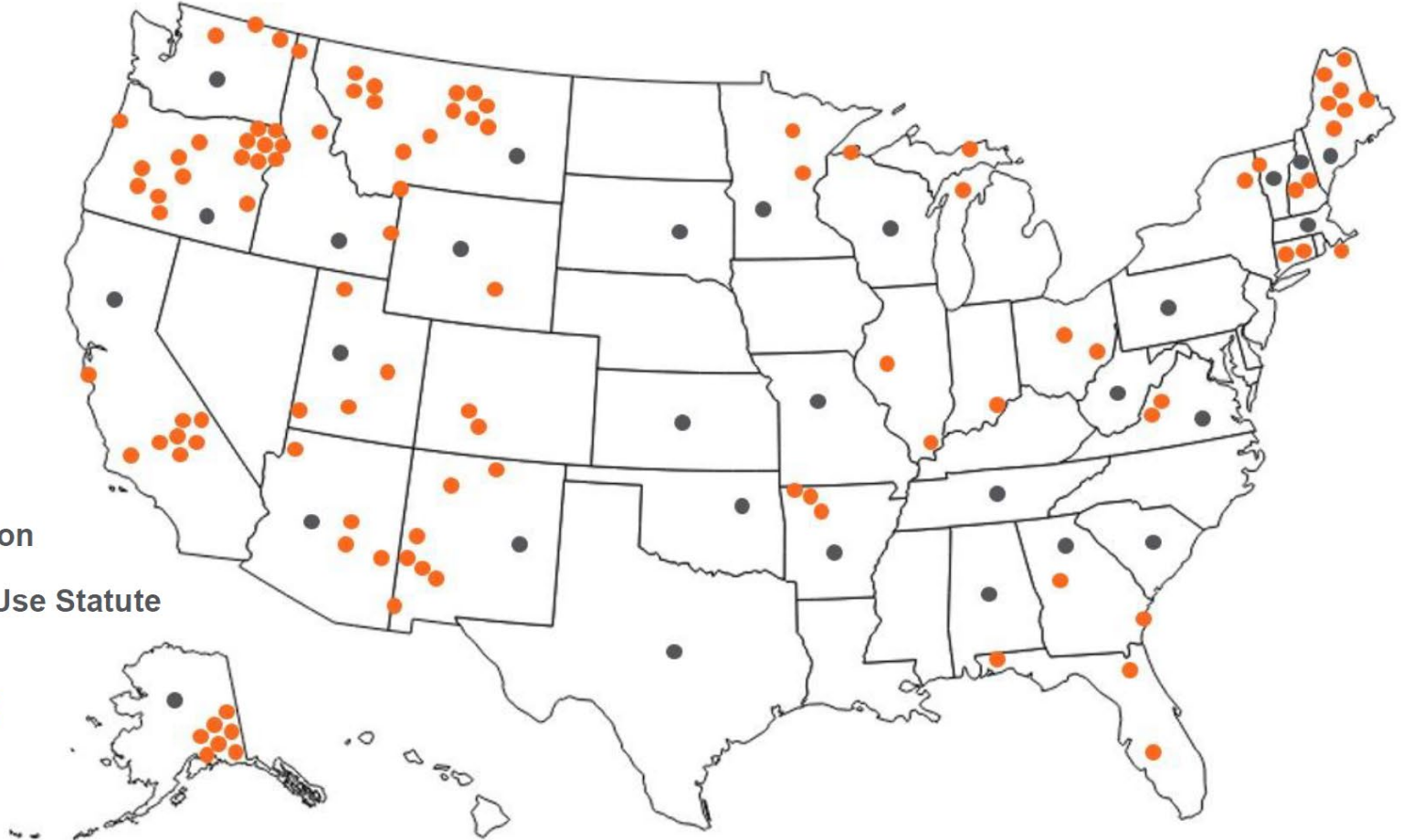

Childs Glacier, AK
May Creek, AK
Fireweed, AK
Bold Airstrip, AK
Paxson, AK
Glacier Creek, AK
Jake's Bar, AK
Richland Creek, AR
Trigger Gap, AR
Sugar Creek, AR
Grand Gulch Mine, AZ
Grapevine, AZ
Double Circle Ranch, AZ
Pleasant Valley, AZ
Lone Pine, CA
New Cuyama, CA
Las Trancas, CA
Minietta Mine, CA
Johannesburg, CA
Kern Valley, CA
Carver's Cut, CA

Chicken Strip, CA
Kent Rominger Airport, CO
La Garita South Fork, CO
Waterbury, CT
Goodspeed, CT
Blackwater, FL
Keystone Heights, FL
Arcadia, FL
Creighton Island, GA
Meadowlark, GA
Ragtown Bar, ID
Big Bar, ID
Cavanaugh Bay, ID
Moose Creek, ID
Driggs, ID
Havana, IL
Henderson, IL
Lee Bottom, IN
Katama, MA
Red Pine, ME
Webber Jones Airstrip, ME

Norridgewock, ME
Fort Kent, ME
Avery Field, ME
Cowboy's Air Ranch, ME
Ragmuff, ME
North Fox Island, MI
Two Hearted, MI
Isle, MN
Bowstring, MN
Ryan Field, MT
Meadow Creek, MT
Schafer Meadows, MT
Spotted Bear, MT
West Yellowstone, MT
Russian Flat, MT
Bozeman, MT
Cow Creek, MT
Black Butte North, MT
Bullwhacker, MT
Left Coulee, MT
Knox Ridge, MT

Woodhawk, MT
Alton Bay, NH
Parlin, NH
Amigos Del Cielo, NM
Negrito, NM
Me-Own, NM
Rainy Mesa, NM
Reserve, NM
Cuba, NM
Grant Besley, NM
Marcy Field, NY
Noble County, OH
Swank Field, OH
Dug Bar, OR
Cache Creek, OR
Salmon Bar, OR
Sluice Creek, OR
Silver Lake, OR
Red's Horse Ranch, OR
Minam Lodge, OR
McKenzie Bridge, OR

Rager Field, OR
Toketee, OR
Wild Billy Lake, OR
Pacific City, OR
Madras, OR
Sunrise Valley, OR
Owyhee Reservoir, OR
Mackie Ranch, UT
Locomotive Springs, UT
Escalante, UT
Mexican Mountain, UT
Barrows Field, VA
Ingalls Field, VA
Allenholm, VT
Stehekin, WA
Sullivan Lake, WA
Avey Field, WA
Cornucopia, WI
Miracle Mile, WY

The RAF Way

- We build lifelong relationships
- We are prepared, persistent, patient, and polite
- We have a bias toward action
- We are humble, honest, and direct
- We do more with less
- We say thank you
- We over communicate
- We work well with others
- We stay in our lane
- We listen
- We are family
- We measure ourselves by airfield saves and smiles





Moose Creek, ID

An aerial photograph showing a lush green landscape. A large, irregularly shaped clearing of grassy land is the central focus, with several dirt roads or paths crisscrossing it. This clearing is surrounded by dense, dark green coniferous forests. In the bottom left corner, a river flows through the forest. The top left corner shows the white wing of an aircraft, indicating the photo was taken from an airplane. The overall scene is a mix of open grassland and dense forest.

Moose Creek, ID



Moose Creek, ID



Moose Creek, ID

Childs Glacier, AK





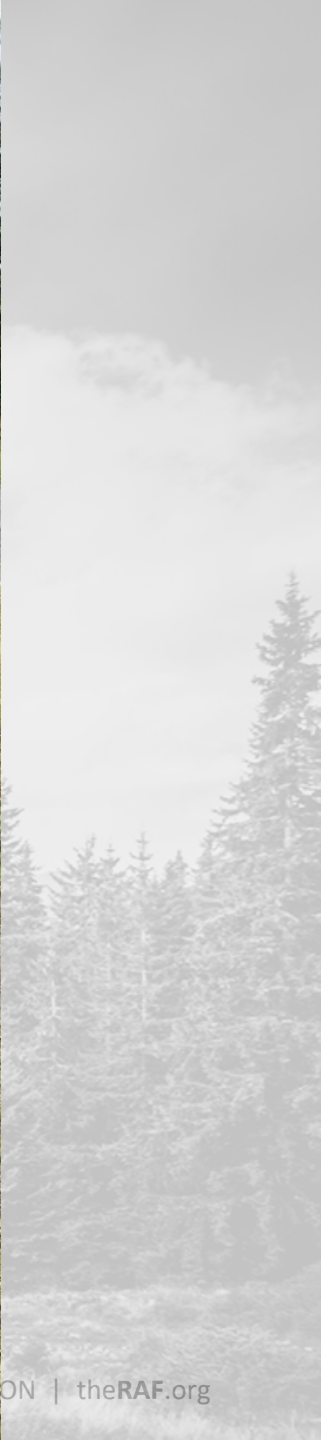

Childs Glacier, AK



Childs Glacier, AK



Childs Glacier, AK



Two Hearted, Michigan (6Y5)



Two Hearted, Michigan (6Y5)



210 nm NE KOSH

Two Hearted, Michigan (6Y5)



Two Hearted, Michigan (6Y5)



North Fox Island, Michigan (6Y3)

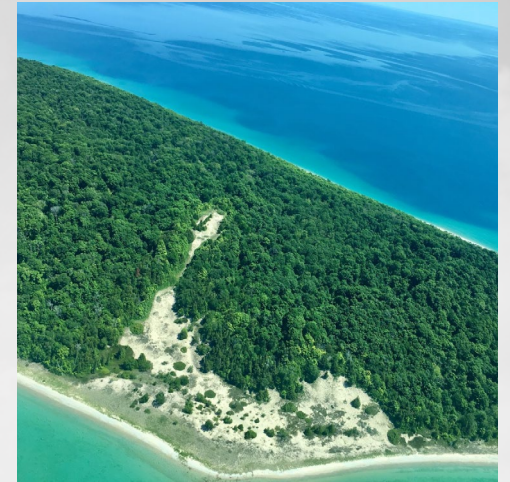

North Fox Island, Michigan (6Y3)



North Fox Island, Michigan (6Y3)



North Fox Island, Michigan (6Y3)



North Fox Island, Michigan (6Y3)



North Fox Island, Michigan (6Y3)



North Fox Island, Michigan (6Y3)



North Fox Island, Michigan (6Y3)



WELCOME TO
CORNUCOPIA



← WISCONSIN'S NORTHERNMOST VILLAGE

Greg Disch
PHOTOGRAPHY

Cornucopia WI

- Largest freshwater lake
- 31,700 sq mi
- Similar to S.C. or Austria
- 1,333 ft max depth
- Enough water to cover N & S America 12" deep
- 191 yr retention



Apostle Islands National Lakeshore



Recreational Opportunities

- Adjacent Apostle Islands
- Kayaking
- Hiking
- Waterfalls
- Biking
- Swimming
- Fishing



Corny Solstice Fly-in



Work Parties



Work Parties



Work Parties



Improvements

- Pilot Shelter
- Electricity in shelter
- Six courtesy bicycles
- Campfire
- Picnic tables
- Five permanent tie downs
- Porti-potti on site
- Firewood rack
- Brushing and tree clearing
- Turf roller
- Grill
- Runway markers
- Camping encouraged



Turf roller donation



Promotion

- Created Cornucopia Airport Facebook page
- Page has 1,100 followers – both pilots and locals



Courtesy of Frank Wellner

Cornucopia Airport
@CornyAirport · ★ 5 (3 reviews) · Airport

[Contact Us](#)
cornucopiawisconsin.net

Home Reviews Videos More

Liked Message

About See all

West Spirit Point Road
Cornucopia, WI 54827

A beautiful grass airstrip in Wisconsin's northernmost village. On the shores of majestic Lake Superior and adjacent to the Apostle Island National Lakeshore.

676 people like this including 182 of your friends

717 people follow this

9 people checked in here

<https://cornucopiawisconsin.net/>

Create post

Photo/video Check in Tag friends

Cornucopia Airport added an event.
May 7 at 8:31 AM



FRI JUN 17 - JUN 19
3rd Annual Corny Solstice Fly-in 2022
Lake Superior Cornucopia, Wisconsin

Interested

Accomplishments

- Transformed a little used airstrip into a desirable recreational destination.
- Airstrip used by well over 100 airplanes annually and growing
- Upgraded airport to support transition from private use to public use.
- Aviators are spending money in local village



Cornucopia WI - Last 12 months



Cornucopia WI - Last 12 months









Cornucopia Airport – public use status as of 19May22



Hanley Field – Munising, MI



Hanley Field – Munising, MI



Pictured Rocks National Lakeshore



Hanley Field – Munising, MI



Hanley Field – Munising, MI



Hanley Field – Munising, MI

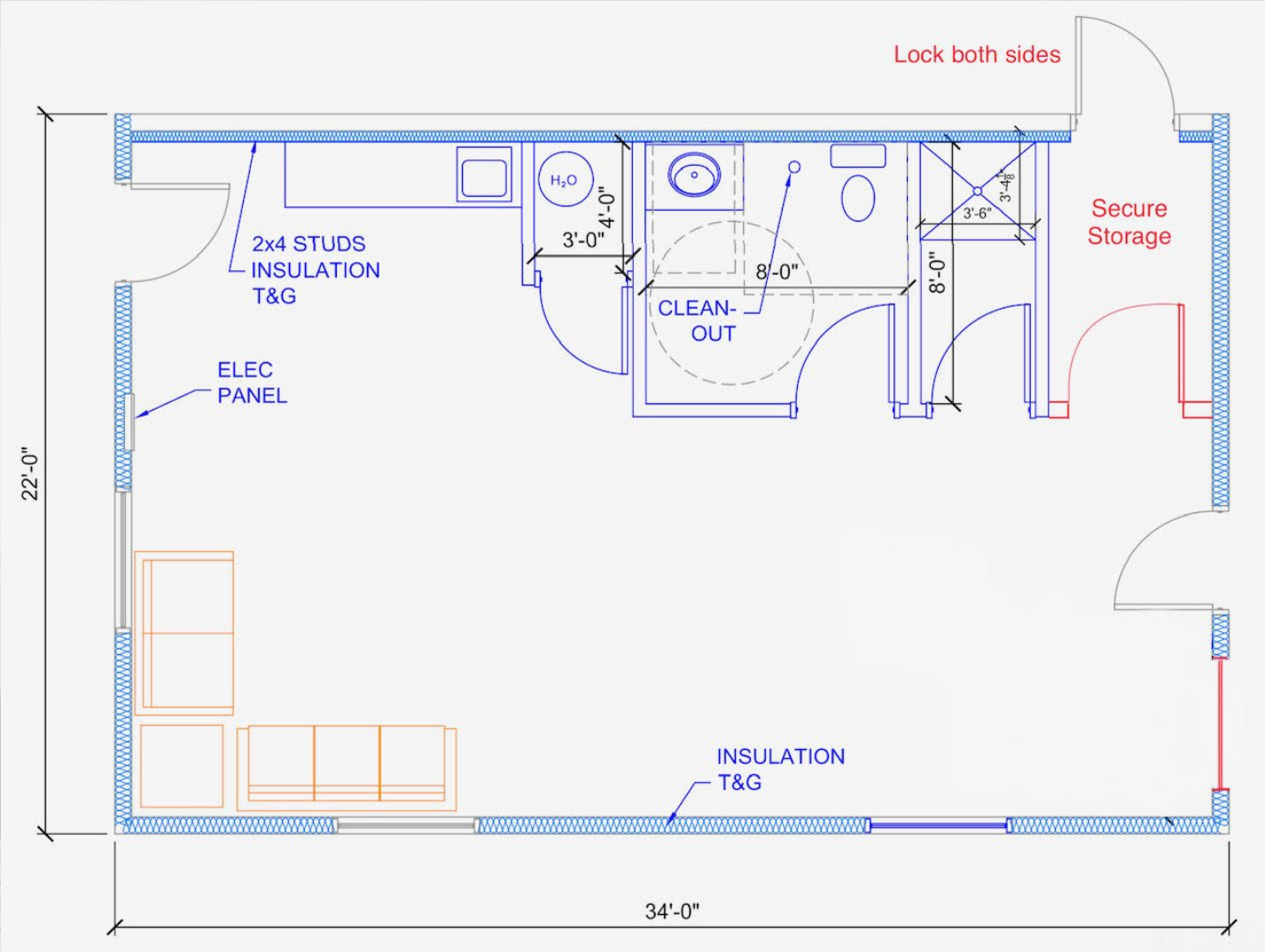

Hanley Field – Munising, MI



Hanley Field – Munising, MI



Hanley Field – Munising, MI



Lakewood Lodge – Stone Lake, WI



Lakewood Lodge – Stone Lake, WI



Lakewood Lodge – Stone Lake, WI



Lakewood Lodge – Stone Lake, WI



Lakewood Lodge – Stone Lake, WI



Your Help is Needed!



Visit theraf.org to learn more about volunteering, or contact Volunteer Coordinator Erin White: ewhite@theraf.org



Thank You

