

# *Welcome!*



## **WISCONSIN AVIATION CONFERENCE**

September 20-22, 2023 • Appleton, WI

**WIAMA.ORG**



# FLEXIBLE RESPONSIVE PERSONAL

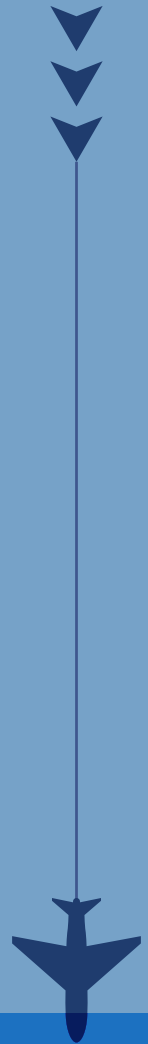

JVIATION IS PROUD TO BE  
A STRONG SUPPORTER OF THE

**WISCONSIN AVIATION CONFERENCE**

**JVIATION®**  
A WOOLPERT COMPANY



# 67th WISCONSIN AVIATION CONFERENCE

September 20-22, 2023 · Appleton, WI

## GREETINGS FROM WAMA

Welcome to the 67th Wisconsin Aviation Conference taking flight in Appleton. We are thrilled to have you join us for this prestigious event, where the skies of knowledge and innovation await your exploration.

Over the next few days, we will embark on a journey celebrating aviation's future, including discussions of environmental issues, operations, funding, technological advancements, and sustainable practices. We designed this conference to elevate our understanding of the aviation industry.

As we gather under the banner of aviation excellence, I encourage you to engage with fellow attendees, share your expertise, and seize the opportunity to forge new partnerships. Let's make the conference venue hallways alive with the buzz of connections made, ideas exchanged, and friendships formed.

Our speaker lineup includes experts who are at the forefront of aviation. Their insights and knowledge will provide invaluable perspectives, inspire new ways of thinking, and equip you with the tools needed to navigate the ever-evolving aviation landscape beyond the conference sessions.

Take a moment to explore the vibrant City of Appleton. Its blend of cultural attractions, charming neighborhoods, and scenic landscapes offers the perfect backdrop for relaxation and rejuvenation.

Thank you for being a part of the 67th Wisconsin Aviation Conference. Your presence enriches the event, and we look forward to sharing an unforgettable experience that will resonate long after the conference concludes. Get ready to take off into a world of limitless possibilities, setting the course for a brighter future in aviation. →

Best regards,

**Rachel Engeler**, President - Wisconsin Airport Management Association

## WELCOME TO OUTAGAMIE COUNTY

On behalf of our administration team and our residents, I am delighted to extend a warm, Northeast Wisconsin welcome as we prepare to host the 67th annual Wisconsin Aviation Conference. We are thrilled to have the opportunity to bring together professionals like yourself to share insights, exchange ideas, and collectively contribute to the advancement of aviation for the State of Wisconsin.

As you know, local airports such as Appleton International Airport (ATW), play a critical role in fostering economic development. According to a 2015 economic impact study conducted by the WI Bureau of Aeronautics, ATW provided \$676 million in economic output and supported 3,200 jobs to the local economy in Outagamie County. By the time the next study is unveiled, we're confident that number will be over \$1 billion!

We are honored to serve as the host for this distinguished conference. Our county boasts a rich aviation heritage and has become a hub for aviation innovation, growth, and development. We're home to a diverse range of aviation companies like Air Wisconsin Airlines, Gulfstream Aerospace, and MaxAir Charter. Additionally, we boast cutting-edge academic facilities at Fox Valley Technical College Public Safety Training Center and Aircraft Rescue Fire Fighting (ARFF) Training Center.

While you're here, I hope you get a chance to enjoy some of the best of Outagamie County including our Performing Arts Center, History Museum at the Castle or any one of our terrific local breweries. Whatever you choose, we know you'll have a good time.

Once again, welcome to Outagamie County. May your time at the Wisconsin Aviation Conference be filled with insightful discussions, fruitful collaborations, and memorable experiences. →

Sincerely,

**Thomas M. Nelson** Outagamie County Executive





**Hilton**  
APPLETON PAPER VALLEY

## Room Key

- 1 Great Hall
- 2 Briarwood/Ebony
- 3 Rosewood/Linden
- 4 Mahler Boardroom
- 5 Lawrence

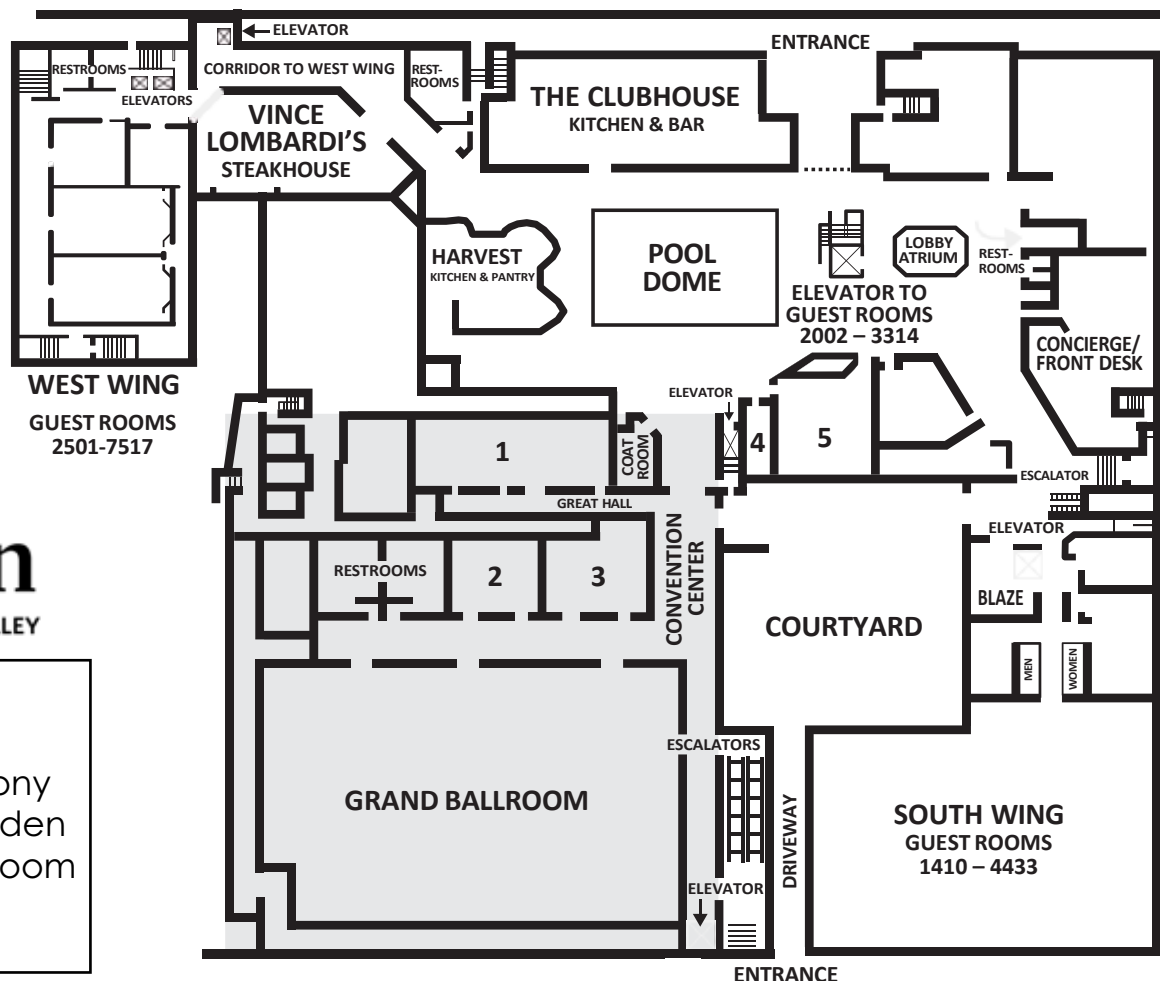

## WISCONSIN AIRPORT MANAGEMENT ASSOCIATION

### Debby Jackson & Luke Pearson

*TDA, Executive Director Services*

### Rachel Engeler, MS

*President – Assistant Airport Director,  
Green Bay Austin Straubel International Airport*

### Jim Schell, C.M.

*Vice President – Airport Director,  
Wittman Regional Airport*

### Matt Grenoble, C.M.

*Treasurer – Airport Superintendent,  
Sheboygan County Memorial Airport*

### Ian Turner, A.A.E.

*Secretary – Airport Director, La Crosse  
Regional Airport*

### Richard Brekke

*Director – Airport Manager,  
Cumberland Municipal Airport*

### Mark Cihlar, A.A.E.

*Director – Assistant Airport Director,  
Central Wisconsin Airport*

### Brian Linger

*Director – Airport Manager,  
Fond du Lac County Airport*

### Harold Mester, C.M.

*Director – Director of Public Affairs  
and Marketing, Milwaukee Mitchell  
International Airport,  
Milwaukee Timmerman Airport*

### Michael Reichers

*Director – Director of Marketing and  
Communications, Dane County  
Regional Airport*

### Kurt Stanich

*Director – Airport Manager, Waukesha  
County Airport*

### Abe Weber, A.A.E.

*Director – Airport Director, Appleton  
International Airport*

### Charity Zich, C.M.

*Director – Airport Director, Chippewa  
Valley Regional Airport*

## WISCONSIN AVIATION CONFERENCE PLANNING COMMITTEE

### Max Platts

*Wisconsin BOA Aeronautical &  
Technical Services Section Chief*

### Janel Dean

*AECOM Central Region - Environment*

**Terry Donovan, PE,** Mead & Hunt  
Aviation Project Manager

**Chris Reis, PE,** Mead & Hunt National  
Engineering Practice Leader - Aviation

**Dulce Ruiz-Moreno,** Interflight Parking  
Vice President & General Manager

**Melissa Underwood,** SEH Senior  
Aviation Planner

Cover Photo: **Staff Sgt. Cameron Lewis**

Conference Magazine Design & Layout:  
**Heidi Miller,** [createdanewdesigns.com](http://createdanewdesigns.com)

*Special thank you to everyone who  
helped make this conference a success!*



See pages 24-29 for additional information about our exhibitors and sponsors.

## GRAND BALLROOM

BOOTH	EXHIBITOR
1	MacQueen Equipment
2	1200.aero
3	Midland Door Solutions / Foremost Buildings
4	EPIC Fuels
5	Fahrner Asphalt Sealers, LLC
6	Becher-Hoppe Associates, Inc.
7	METCO, Inc.
8	Wisconsin Concrete Pavement Association
9	Helena Agri-Enterprises
10	ProSource
11	NV5 Geospatial
12	Keller, Inc.
13	Century Fence
14	Diaz Group LLC
15	Airport Lighting Company
16	Westwood
17	TITAN Aviation Fuels
18	Mead & Hunt
19	World Fuel Services
20	CBS Squared, Inc.
21	Hali-Brite, Inc.
22	MSA Professional Services, Inc.
23	Wisconsin Surplus Online Auction
24	Arrow Energy, Inc.
25	Pro-Tec Fire Services
26	TKDA
27	Veregy
28	The Green Earth Deicer Company, Inc.
29	Interflight Parking
30	SEH
31	Westmor
32	M-B Companies

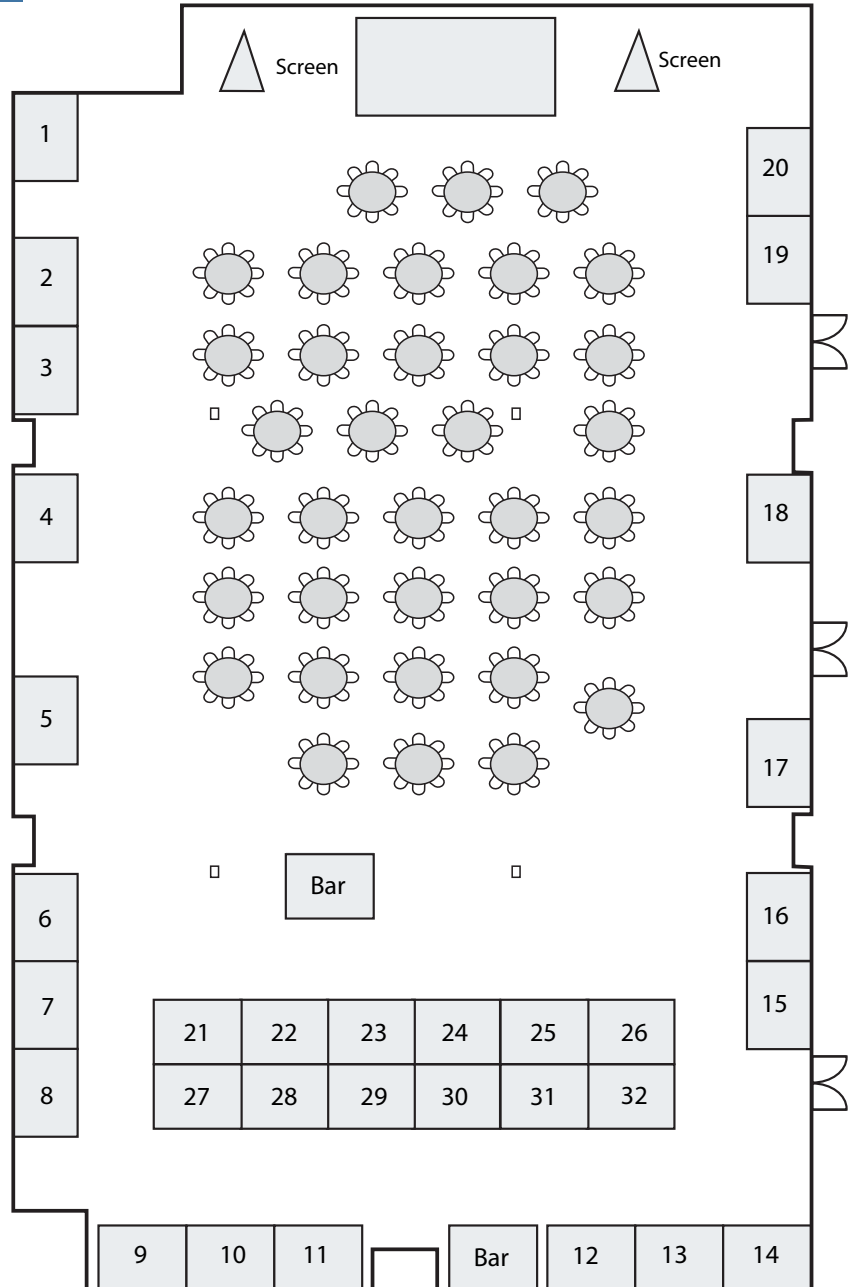

## WEDNESDAY, SEPTEMBER 20<sup>TH</sup>

10:00 a.m. – 5:00 p.m.	Onsite Conference Registration – <i>Hotel Lobby, South Side of Pool Dome</i>
11:00 a.m. – 4:00 p.m.	Basics of Airport Management Seminar – <i>Rosewood/Linden</i>
11:00 a.m.	Golf Outing at Reid Golf Course
12:00 – 4:00 p.m.	Exhibit Hall Set Up – <i>Grand Ballroom</i>
1:00 p.m.	VIP Gulfstream Tour
1:00 p.m.	Trap Shooting at the Outagamie Conservation Club
4:30 – 5:30 p.m.	Exhibit Hall Social Hour – <i>Grand Ballroom</i>
5:30 – 9:00 p.m.	Dinner and Entertainment at the 513

## THURSDAY, SEPTEMBER 21<sup>ST</sup>

7:30 – 8:45 a.m.	Breakfast with Exhibitors – <i>Grand Ballroom</i>
7:30 a.m. – 4:00 p.m.	Onsite Conference Registration – <i>Hotel Lobby, South Side of Pool Dome</i>
8:00 – 8:50 a.m.	WAMA Annual Membership Meeting – <i>Great Hall</i>
9:00 – 9:10 a.m.	Conference Welcome – <i>Grand Ballroom</i>
9:10 – 9:40 a.m.	General Session – <i>Grand Ballroom</i>
9:40 – 10:20 a.m.	General Session – <i>Grand Ballroom</i>
10:20 – 10:40 a.m.	Refreshment Break with Exhibitors – <i>Grand Ballroom</i>
10:40 – 11:20 a.m.	General Session – <i>Grand Ballroom</i>
11:20 – 11:45 a.m.	General Session – <i>Grand Ballroom</i>
11:45 a.m. – 12:45 p.m.	Awards and Sponsor Recognition Luncheon – <i>Grand Ballroom</i>
1:00 – 4:30 p.m.	One-On-One “Planning on the Fly” Meetings – <i>Mahler Boardroom</i>
1:00 – 1:45 p.m.	Concurrent Professional Sessions
2:00 – 2:45 p.m.	Concurrent Professional Sessions
2:45 – 3:15 p.m.	Refreshment Break with Exhibitors – <i>Grand Ballroom</i>
3:15 – 4:00 p.m.	Concurrent Professional Sessions
4:30 – 5:30 p.m.	Reception with Exhibitors – <i>Grand Ballroom</i>
5:30 – 9:00 p.m.	Networking Event and Dinner – <i>Hotel Courtyard and Blaze</i>

## FRIDAY, SEPTEMBER 22<sup>ND</sup>

7:00 – 8:00 a.m.	Breakfast with Exhibitors – <i>Grand Ballroom</i>
8:00 – 10:30 a.m.	One-On-One “Planning on the Fly” Meetings – <i>Mahler Boardroom</i>
8:00 – 8:45 a.m.	General Session – <i>Grand Ballroom</i>
8:45 – 9:30 a.m.	Concurrent Sessions
9:30 – 10:00 a.m.	Refreshment Break with Exhibitors – <i>Grand Ballroom</i>
10:00 – 10:45 a.m.	General Session – <i>Grand Ballroom</i>
10:45 a.m.	Final Remarks – <i>Grand Ballroom</i>
11:00 a.m.	Exhibit Hall Tear Down – <i>Grand Ballroom</i>



AIRPORT PLANNING, ENVIRONMENTAL, DRONE TECHNOLOGY,  
ARCHITECTURE, DESIGN, AND CONSTRUCTION

# SOLVING YOUR MOST COMPLEX AIRPORT CHALLENGES.

Stop by the SEH booth to say hello and find solutions!



Building a Better World for All of Us®

Engineers | Architects | Planners | Scientists

Ryan Falch | Melissa Underwood | 800.325.2055 | [sehinc.com/subscribe](http://sehinc.com/subscribe)

Thank you to the following sponsors for supporting the Wisconsin Aviation Conference. Sponsorships allow the conference committee to hold the registration fees at an affordable level without compromising the quality of the conference.

## CORPORATE EXCELLENCE



## PLATINUM



## GOLD

Avfuel Corporation  
Cooper Engineering  
Crawford, Murphy & Tilly, Inc.

Pro-Tec Fire Services  
SP Plus Airport Services  
Veregy

## SILVER

Appleton Flight Center  
Applied Pavement Technology, Inc.  
The Aviation Planning Group  
Benesch  
Burns & McDonnell  
CBS Squared, Inc.  
Endpoint Solutions

Halliday Technologies  
HUB Parking/TIBA Parking  
Leibowitz & Horton Airport Management Consultants, Inc.  
Nielsen Madsen + Barber  
Sherwin Industries, Inc.  
UW Oshkosh Online and Continuing Education



## BOA EMBARKS ON NEW ECONOMIC IMPACT STUDY

The Wisconsin Department of Transportation, Bureau of Aeronautics (BOA) has undertaken a new economic impact study for public commercial and general aviation airports, selecting Jviation, a Woolpert Company, to conduct the study. The staff working on the project has completed more than 30 similar studies for other states.



Passengers departing Milwaukee Mitchell International Airport.  
(Photo/Milwaukee Mitchell International Airport)

Jviation will collect information and report annual estimated economic impacts for airport management, airport business tenants, average annual capital investment, and general aviation visitor spending. They will report employment, payroll, spending, and total yearly economic activity results.

The data will provide the BOA, airports, aviation stakeholders, elected officials, communities, and others with important information on the economic contributions of each airport and statewide impacts.



Dusk at the world's busiest fly-in.  
(Photo/Wittman Regional Airport)

The BOA economic impact study staff have completed the initial step in the data collection process. This portion of the process included documenting the results of the first group of surveys from airports, business tenants, and visitors, along with a webinar. The next steps in the study will be to finish collecting data, analyze the direct impacts, and measure airports' annual economic activity.

In late August, the BOA held the first of three planned project webinars for airports to provide information on the study process, products, and schedule and share the preliminary results from the initial surveys. Some of the findings include 1.8 million visitors arriving annually on commercial airline flights and more than 400,000 on general aviation aircraft. Additionally, there were more than 300 business tenants at the studied airports.



FedEx at sunrise.  
(Photo/Milwaukee Mitchell International Airport)

We thank the Wisconsin airports for their participation in responding to surveys and inquiries. These timely and thorough responses will give Wisconsin's airports a more robust Economic Impact Study outcome. WisDOT expects the study to be complete in the spring of 2024. ➔

Wisconsin Department of Transportation,  
Bureau of Aeronautics

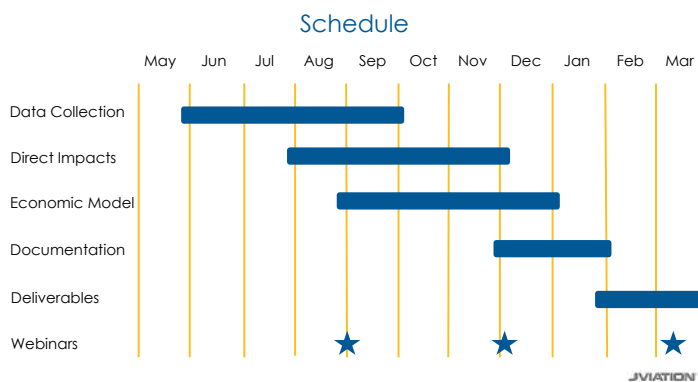

# EAA'S 70<sup>TH</sup> ANNIVERSARY GATHERING IS A RECORD BREAKER



An overhead view of the first EAA fly-in convention, held in September 1953 at Curtiss-Wright Airport (now Timmerman Airport) in Milwaukee. (EAA Archives)

In September 1953, 21 airplanes and about 150 people gathered for the first Experimental Aircraft Association fly-in convention, at what's now Timmerman Airport in Milwaukee.

Seven decades later, that number of airplanes and people account for about one row of aircraft parking at Wittman Regional Airport in Oshkosh.



EAA's 70th anniversary logo was part of the vintage Ercoupe that was the grand prize for the organization's annual airplane raffle. (EAA photo/Bernie Koszewa)

The 70th anniversary edition of EAA AirVenture Oshkosh on July 24-30 was a remarkable milestone, not just for longevity. A record-shattering attendance of 677,000 came to Oshkosh, with the logistics involving coordination between EAA staff and volunteers, Wittman Regional Airport personnel, the FAA, and countless other entities that make it happen.

"We had record-setting totals of campers, exhibitors, volunteers, and more. It was also a challenging year at times with weather, logistics, and other factors, which makes me even more proud of the efforts by our volunteers and staff to organize an outstanding event," said Jack Pelton, EAA's CEO and Chairman of the Board.

That included expanding Camp Scholler several times during the week, creating camper overflow areas to accommodate all the EAA members and other aviation enthusiasts who came to Oshkosh for what is affectionately known as "aviation's annual family reunion." In all, people from all 50 states and a record-tying 93 other nations came to see more than 3,300 showplanes, participate in more

than 1,400 forums and workshops, and visit the 848 exhibitors (another all-time high).

While the main action took place at Wittman Regional Airport in Oshkosh, which returned as the world's busiest airport for one week with nearly 22,000 aircraft operations over 11 days, airports throughout Wisconsin played a role in AirVenture's success. Appleton International Airport hosted flight experiences by a B-25, B-17, and B-29. Fond du Lac County Airport saw hundreds of airplanes parked at that facility, and airfields from Milwaukee to New Holstein welcomed AirVenture-related traffic.

AirVenture 2023 was also the pinnacle of EAA's yearlong 70th anniversary commemoration as an organization. The original anniversary logo was visible everywhere on the grounds, from the flags over the iconic Brown Arch that led to the flightline to the tail of the vintage Ercoupe that was the grand prize in the annual airplane raffle.



The "Four Corners" leading to the Boeing Plaza showcase ramp at EAA AirVenture Oshkosh 2023. Boeing Dreamliner cargo airplane is in the background. (EAA photo/Laurie Goossens)

The 70th anniversary logo was itself a part of EAA history. The "EAA" lettering was based on one of the three initial designs for the organization's original logo in 1953 and adapted to fit the anniversary's modern requirements.

The three dozen people who met in January 1953 to form EAA would be hard-pressed to believe what has evolved in the seven decades since that first meeting. EAA now has more than 275,000 members in 100-plus countries and an event that brings the world to Wisconsin every year, making the word "Oshkosh" synonymous with aviation.

Some things remain the same, however: The EAA spirit of "member helping member," the local involvement of EAA chapters, and the efforts to break down barriers to allow more people to participate in aviation. As EAA begins its eighth decade, the size and scope of AirVenture continues to mirror all the elements of the organization that, as EAA founder Paul Poberezny said long ago, is "open to anyone who wants to participate." ➔

Dick Knapinski

Director of Communications, EAA





**SOLUTIONS  
FOR YOUR  
SUCCESS.**



# Westwood

**PROFESSIONAL SERVICES, INC.**



*We are solutions driven. Whether it be for our clients, communities or each other – we help others succeed.*

**Aaron Stewart, PE, Aviation Services Manager | [aaron.stewart@westwoodps.com](mailto:aaron.stewart@westwoodps.com)**

Westwood is a full-service, multi-discipline professional engineering firm and serves wind, solar, power delivery, private development, and public infrastructure clients and their projects from multiple offices across the U.S.

**920.735.6900 | [westwoodps.com](http://westwoodps.com) | 1 Systems Drive Appleton, WI 54914**

# 2023 AWARD WINNERS

## Airport Engineer Award:

**Terry Donovan, PE**

Terry has been with Mead & Hunt since graduating with a Civil Engineering degree from UW-Platteville. He is the project manager for Southern Wisconsin Regional Airport, Dane County Regional Airport, Seymour Johnson Air Force Base in South Carolina, and routinely assists with other airport projects. He is a tremendous asset, contributing to the success of the airports with which he works. He balances complex projects at multiple airports while ensuring projects are completed safely. Terry goes the extra mile, often working after hours to ensure projects stay on track. Additionally, he volunteers his time, serving on the Wisconsin Aviation Conference planning committee to provide a high-quality WAC event for the benefit of all airports in Wisconsin.

## Distinguished Service Award:

**Charity Zich, C.M.**

Charity has served the users of the Chippewa Valley Regional Airport for 17 years as the airport director. She continually makes outstanding contributions to Wisconsin aviation through her tenure at the airport and on the WAMA Board of Directors. Charity has helped the board keep its past in sight while working on the airport challenges of today and tomorrow. Her uniquely pragmatic problem-solving approach has been most evident in her successful efforts over the years to keep commercial air service at her airport. Charity is a leader in her community and the larger aviation community in Wisconsin and beyond.

## Lifetime Service Award:

**Bob O'Brien**

Bob worked in the aviation industry for nearly four decades – for airports and WAMA. He served in leadership roles at various airports throughout Wisconsin, Indiana, Iowa, Illinois, Minnesota, and Georgia. The list of airports is long, including Madison, Green Bay, La Crosse, Platteville, Fort Wayne, IN; Dubuque, IA; Springfield, IL; Brainerd, MN; and Columbus, GA. In 2012, after nine years of running the Chicago Rockford International Airport, Bob was appointed the executive director of WAMA and served in that position until 2020. He also served 20 years in the U.S. military, mostly in the National Guard and Army Reserves.

## Blue Light Award:

**Dick Knapinski**

Dick has promoted aviation for more than thirty years. He has been EAA's director of communications since January 2010, having advanced to that position after serving as a member of EAA's public relations/marketing staff since 1992. His responsibilities include liaising with the media representatives who report on EAA activities throughout the year. Those activities include the annual EAA AirVenture Oshkosh fly-in, which has a yearly attendance of more than 600,000 and draws 10,000 airplanes and over 800 international media members to Oshkosh. Before joining the EAA staff, Dick worked for broadcast and print media outlets throughout Wisconsin. He continues to contribute as a writer for newspapers and magazines, and he co-authored the book *EAA Oshkosh: The Best Aviation Photography*.

## Person of the Year Award:

**Abe Weber, A.A.E.**

Abe, airport director at Appleton International Airport, has served on the WAMA Board of Directors since 2012 and is a past president of the organization. He has been an active leader in the organization's advocacy, leading past efforts to pass sales tax exemptions for aviation parts and labor in Wisconsin. As a WAMA governmental affairs committee member, Abe has shepherded efforts to pass legislation to help the state's airports deal with nuisance wildlife over the past year. He continues to look for opportunities to improve aviation for all Wisconsin airports.



TSA's Frank Pipia receiving the Blue Light Award in 2022



## Lifetime Service Award

1981	Robert Skuldt
1982	Libby Parod
1983	Fritz Wolf
1984	Bob White
1985	Carl Rindlisbacher
1986	Charles Wood
1987	Harry Chaplin
1988	Carl Guell
1989	Paul Poberezny
1990	Phil Leyda
1991	Earl Pingel
1992	Walter Mayo
1993	Howard Morey
1994	Robert Acker
1995	Warren Basler
1996	Field Morey
1997	Duane E. Esse
1998	Harold (Duffy) Gaier
1999	Mary Millard
2000	William H. Green
2001	Doug Bake
2003	Robert Kunkel
2004	Robert G. Heck
2005	Thom Thomas
2006	James Hansford
2007	Bob Egan
2008	Peter Drahn
2009	Lee Perrizo
2010	C. Barry Bateman
2011	Ton Sneig
2012	Dan Wruck
2013	Jerry Stites
2014	Joseph Brauer
2015	Don Winkler
2016	Tony Yaron
2017	Eileen Duffeck
2018	Ron Burdick
2019	David Mann
2021	David Jensen
2022	Randy Van Natta
2023	Bob O'Brien

## Airport Engineering Award

1983	Thomas Janssen
1984	Joe Abernathy
1985	Leo Bussan
1986	Al Fawley
1987	Bill Green
1988	James Foley
1989	Dave Dyrstad
1990	Keith Lindsley
1991	Mike Hinz
1992	Leroy Gilhausen
1993	Andrew Platz
1994	Roy Eckrose
1995	Mike Kirchner
1996	Phil Ramlet
1997	Roy Gilhausen
1998	David Elder
1999	Boyd Schleicher
2000	David Phillips
2001	Tom Janssen, Jr.
2003	Bryan Page
2004	Wendy Hottenstein
2005	Aaron Stewart
2006	Randy Van Natta
	Kevin Lang
2007	Kevin Sielaff
2008	Lisa Kinsman
2009	Laura Morland
2010	Mark Porlier
2011	Ed Baisch
2012	Greg Stern
2013	Jim Zsebe
2014	Christopher Reis
2015	Steve Opatik
2016	Marcus Kuhn
2018	Kim Kaarto
2019	Mark Graczykowski
2021	Kevin Kunde
2022	Ryan Falch
2023	Terry Donovan

## WAMA Distinguished Service Award

2000	Don Hoeft
	Phill Scherer
2001	Irene Enamual
2002	Thom Thomas
2003	Gary Dikkers
2004	Peter Drahn
2005	James Hansford
	Ray Perry
	Marilen Butler
2006	Dave Johnson
2007	John Chmiel
	Ruth Elliott,
	Patrick Mattson
2008	Jeff Gaier
	Helena Ziegler
2009	John Dorcey
2010	Clint Torp
2011	David Obey
2012	Matt Dubbe
2013	Marty Lenss
2015	John Reed
2016	Allan Seirstad
	Dave Elder
2017	Barry Cooper
2018	Joe Brauer
2019	Clint Torp
2021	Mike Paffel
2022	Michael Stephens
2023	Charity Zich

## WAMA Blue Light Award

2013	Meg Jones
2015	Chris Hubbuch
2017	John Schoenknecht
2019	Hal Davis
2022	Frank Pipia
2023	Dick Knapinski

## WAMA Green Light Award

2014	Barry Bateman
------	---------------

## Person of the Year Award

1969	S. J. Wittman
1970	Howard Morey
1971	Francis Higgins
1973	T. K. Jordan
1974	Ed Williams
1975	Marie Grimm
1976	Robert Heck
1977	Paul Poberezny
1978	Roy Shwery
1979	Dave Duax
1980	Basil Arvey
1981	Marilyn Hardacre
1982	Joe Liebergen
1983	Wally Mitchell
1984	Preston Wilbourne
1985	Fred Gammon
1986	George McQueen
1987	LeRoy Jonas
1988	James Ash
1989	Art Borchardt
1990	Timothy Hoeksema
1991	Charles E. Swain
1992	Tom Poberezny
1993	Lyle Maves
1994	Dennis Eiler
1995	James Conn
1996	C. Barry Bateman
1997	Peter Drahn
1998	James Hansford
1999	Joseph Brauer
2000	Diane Ballweg
2001	Don Hoeft
2003	Jeff Baum
2004	Russ Decker
	Mark Meyer
2005	Marty Lenss
2007	Tony Yaron
2008	James Kerr
2009	Jeff Skiles
2010	Rose Dorcey
2011	Tom Miller
2012	Michael Goc
2014	Abe Weber
2015	Ben DeLeon
2017	Lt Col., Chris Hansen
2018	Mary Strait
2021	Charity Zich
2022	Josh Holbrook
2023	Abe Weber

*Congratulations!*



Proud Sponsor of the  
67th Wisconsin Aviation Conference



## A Full Service Airport Marketing Partner

focused on communicating the right message at the right time to reach your target audience and decrease leakage while increasing enplanements, passenger retention, and commitment to fly local.

Marketing Strategy • Creative Concepting • Market Research • Video Production  
Online Display • Print Advertising • Location Based Mobile • SEM • SEO • Social Media  
Website & Landing Page Development • Traditional Media Buying/Planning



**Experienced Aviation Experts**



**Proven Marketing Tactics**



**Award-Winning Creative**

**A marketing partner with more**

**[AdvanceAviationMarketing.com](http://AdvanceAviationMarketing.com)**



# FLY WISCONSIN PASSPORT PROGRAM

**Hal Davis, C.M.** | Airport Compliance Manager  
Wisconsin Department of Transportation | Bureau of Aeronautics

Top off the tanks and check the weather. It's time to Fly Wisconsin! The Wisconsin Department of Transportation Bureau of Aeronautics and the Wisconsin Airport Management Association continue to team up to bring an airport passport program to Wisconsin. Pilots and their passengers may earn awards by flying into Wisconsin airports, attending FAA safety seminars, and visiting Wisconsin's aviation attractions.

The program launched September 1, 2017.  
Since then, over 2,500 participants have registered!

**To find out more and to register, visit:**  
**[wisconsin.gov/flywi](https://wisconsin.gov/flywi).**

*Mail-in registration cards can also be found at your local airport.*



## FLY WISCONSIN PASSPORT FINISHERS

### GOLD LEVEL

Name	Year Finished	Name	Year Finished	Name	Year Finished
John Alferi	2021	Stephen Benesh	2022	Anastasiia Shevchuk	2022
Timothy Lemke	2021	Gerald Clabots	2022	Edward Trembl	2022
Douglas Osborn	2021	Greg Clabots	2022	Sydney Cohen	2023
Mark Peterson	2021	Dean Forrest	2022	Michael Morrow	2023
Philip Peterson	2021	Joseph Mapes	2022	Mark Owen	2023
Igor Zhukov	2021	Sue Meise	2022	Gregory Patchel	2023

### SILVER LEVEL

Name	Year Finished	Name	Year Finished	Name	Year Finished
Sue Meise	2021	Stephen Benesh	2022	Sydney Cohen	2023
Douglas Osborn	2021	Dean Forrest	2022	Dennis Davis	2023
Mark Peterson	2021	Jan Lee	2022	Debi Lett	2023
Philip Peterson	2021	Pat Lee	2022	Brian Lett	2023
Addison Tower	2021	Patrick Lee, Jr.	2022	Michael Morrow	2023
Edward Trembl	2021	Joseph Mapes	2022	Mark Owen	2023
Igor Zhukov	2021	Anastasiia Shevchuk	2022	Gregory Patchel	2023

### BRONZE LEVEL

Name	Year Finished	Name	Year Finished	Name	Year Finished
Carol Davis	2021	Stephen Benesh	2022	Joseph Mapes	2022
Tom Davis	2021	Scott Catlin	2022	Anastasiia Shevchuk	2022
Rebecca Formella	2021	Lisa Davis	2022	Sydney Cohen	2023
Andrew Formella	2021	Dennis Davis	2022	Debi Lett	2023
Robert Martier	2021	David Dunn	2022	Brian Lett	2023
Mark Peterson	2021	Gail Dunn	2022	Katherine Morrow	2023
Philip Peterson	2021	Dean Forrest	2022	Michael Morrow	2023
Charles Read	2021	Lauren Labs	2022	Mark Owen	2023
Sara Siddiqui	2021	Mathieu Labs	2022	Gregory Patchel	2023
Bob Vajgrt	2021	Jan Lee	2022	Dwight Simpson	2023
Dawn Vajgrt	2021	Pat Lee	2022		
Igor Zhukov	2021	Patrick Lee, Jr.	2022		

## Wednesday, September 20, 2023

- 10:00 a.m. – 5:00 p.m. **ONSITE CONFERENCE REGISTRATION** – *Hotel Lobby, South Side of Pool Dome*
- 11:00 a.m. – 4:00 p.m. **BASICS OF AIRPORT MANAGEMENT SEMINAR** – *Rosewood/Linden*  
*Brought to you by: Mead & Hunt and Westwood*
- 11:00 a.m. **GOLF OUTING AT REID GOLF COURSE**  
 Meet at the course, 1100 E. Fremont Street in Appleton, a short drive from the Hilton Appleton Paper Valley. Shotgun start at 11 a.m.  
*Sponsored by: Mead & Hunt*  
*Hole prizes by: Veregy*
- 12:00 – 4:00 p.m. **EXHIBIT HALL SET UP** – *Grand Ballroom*
- 1:00 p.m. **VIP GULFSTREAM TOUR**  
 Join the tour at Gulfstream, N687 Discovery Drive, Appleton, about five miles from the Hilton Appleton Paper Valley. Only participants registered one week in advance and approved by Gulfstream can take part in the tour.
- 1:00 p.m. **TRAP SHOOTING AT THE OUTAGAMIE CONSERVATION CLUB**  
 Meet at the club, N3502 Mayflower Road, Hortonville, a little more than ten miles from the Hilton Appleton Paper Valley. Trap Shooting starts at 1:00 p.m.  
*Sponsored by: Westwood*
- 4:30 – 5:30 p.m. **EXHIBIT HALL SOCIAL HOUR** – *Grand Ballroom*  
 Join the exhibitor passport program taking flight! Conference attendees receive a conference passport at registration. Fill up your passport and turn it in by 9:00 a.m. on Friday for a chance to win a \$400 Visa gift card! The winner will be drawn during Friday's morning break. You must be present to win.  
*Sponsored by: Jviation, a Woolpert Company*
- 5:30 – 9:00 p.m. **DINNER AND ENTERTAINMENT AT THE 513**  
 You don't want to miss this! Just a few blocks from the hotel at 513 W. College Avenue, the WAC 67 kick-off dinner will include a sumptuous Italian buffet followed by the NEW Dueling Pianos. Their request-based, interactive, hilarious, sing-along, clap-along show is guaranteed to be a good time.  
*Sponsored by: Advance Aviation and Mead & Hunt*

### WHAT'S THE STORY BEHIND THE COVER PHOTO?



F-35 Lightning II aircraft assigned to the 115th Fighter Wing, Truax Field, Madison, Wisconsin, take their first flight to Truax Field on April 25, 2023. These are the first F-35s to be assigned to the fighter wing since beginning the aircraft conversion from the F-16 Fighting Falcon in 2020. →

U.S. Air National Guard photo by Staff Sgt. Cameron Lewis



## Thursday, September 21, 2023

7:30 – 8:45 a.m. **BREAKFAST WITH EXHIBITORS** – *Grand Ballroom*

*Sponsored by:* **AECOM and Coffman Associates**

7:30 a.m. – 4:00 p.m. **ONSITE CONFERENCE REGISTRATION** – *Hotel Lobby, South Side of Pool Dome*

8:00 – 8:50 a.m. **WAMA ANNUAL MEMBERSHIP MEETING** – *Great Hall*

9:00 – 9:10 a.m. **CONFERENCE WELCOME** – *Grand Ballroom*

*Speakers:* Rachel Engeler, MS, Assistant Airport Director, Green Bay Austin Straubel International Airport  
Outagamie County Executive Thomas Nelson

### GENERAL SESSION

9:10 – 9:40 a.m. **INTRODUCTION TO GULFSTREAM AEROSPACE APPLETON**

**Grand Ballroom**

Hear how Gulfstream Aerospace in Appleton, Wisconsin, delivers the art of excellence through the strongest and most advanced fleet in its history.

*Speaker:* Josh Bartoszuk, Director – Site Materials, Gulfstream Aerospace

*Moderator:* Abe Weber, A.A.E., Airport Director, Appleton International Airport

9:40 – 10:20 a.m. **FAA UPDATE WITH Q&A**

**Grand Ballroom**

The Federal Aviation Administration will provide essential updates. Learn how the FAA's priorities and activities will impact your organization. Bring your questions and ideas to this interactive session.

*Speakers:* Erik Amend, Regional Administrator, Great Lakes Region, FAA  
Susan Mowery-Schalk, Director, Airports Division Great Lakes Region, FAA  
Deb Bartell, Manager, Chicago Airports District Office, FAA

*Moderators:* Rachel Engeler, MS, Assistant Airport Director, Green Bay Austin Straubel International Airport  
Abe Weber, A.A.E., Airport Director, Appleton International Airport

10:20 – 10:40 a.m. **REFRESHMENT BREAK WITH EXHIBITORS**

**Grand Ballroom**

Use this time to visit with exhibitors and fill up your passport. Turn it in by 9:00 a.m. on Friday for a chance to win a \$400 Visa gift card! The winner will be drawn during Friday's morning break.

NEW this year, WAMA is conducting a 50/50 raffle to support future professional scholarships. Purchase your tickets at the registration table or a station in the general session room during today's breaks. The winner will be drawn during tonight's dinner.

You must be present to win.

*Sponsored by:* **TKDA and TITAN Aviation Fuels**

## Thursday, September 21, 2023 [continued]

### GENERAL SESSION

10:40 – 11:20 a.m.  
**Grand Ballroom**

#### BOA UPDATE WITH Q&A

Meet Wisconsin Bureau of Aeronautics staff and hear what's new at the BOA. Learn how the BOA is working to deliver the increased investment from the Bipartisan Infrastructure Law (BIL) and much more. Q&A to follow a short briefing, so come with your questions.

*Speakers:*

*David Greene, Director, Wisconsin BOA  
Tami Weaver, Airport Program Section Chief, Wisconsin BOA  
Matt Malicki, PE, Airport Engineering Section Chief, Wisconsin BOA  
Lucas Ward, Airport Construction Standards Chief, Wisconsin BOA  
Max Platts, Aeronautical & Technical Services Section Chief, Wisconsin BOA*

*Moderators:*

*Rachel Engeler, MS, Assistant Airport Director, Green Bay Austin Straubel International Airport  
Abe Weber, A.A.E., Airport Director, Appleton International Airport*

11:20 – 11:45 a.m.  
**Grand Ballroom**

#### MAKING THE MOST OF YOUR BIL FUNDING

Through the Bipartisan Infrastructure Law's (BIL) Airport Improvement Grant (AIG) program, funding is available to each airport that is part of the National Plan of Integrated Airport Systems (NPIAS), which includes up to 79 Wisconsin non-primary airports. BIL AIG is like the annual non-primary entitlements, but what is dissimilar is how the funding is obtained compared to the Block Grant through the Airport Improvement Program (AIP). This presentation will run through the funding available, how long it will be available, the differences in obtaining BIL versus AIP, and most importantly, emphasize the need to plan how to use BIL funding at your airport.

*Speaker:*

*Mark Graczykowski, PE, Airport Program Engineer, Wisconsin BOA*

*Moderators:*

*Rachel Engeler, MS, Assistant Airport Director, Green Bay Austin Straubel International Airport  
Abe Weber, A.A.E., Airport Director, Appleton International Airport*

11:45 a.m. – 12:45 p.m.  
**Grand Ballroom**

#### ASSOCIATION AWARDS AND SPONSOR RECOGNITION LUNCHEON

Fly Wisconsin Airport Passport Program

See page 15 for a complete list of award winners.

*Moderators:*

*Rachel Engeler, MS, WAMA President  
Jim Schell, C.M., WAMA Vice President  
Kurt Stanich, WAMA Board Member*

*Sponsored by:*

***Becher Hoppe Associates, Inc. and M-B Companies***

1:00 – 4:30 p.m.  
**Mahler Boardroom**

#### ONE-ON-ONE "PLANNING ON THE FLY" MEETINGS BETWEEN AIRPORTS, BOA & FAA CHICAGO AIRPORTS DISTRICT OFFICE (FAA ADO)

This is your opportunity as an airport sponsor to meet with the Chicago Airports District Office (ADO) representatives and the BOA about issues specific to YOUR airport. You must have signed up in advance for an appointment.

# Thursday, September 21, 2023 [continued]

## CONCURRENT PROFESSIONAL SESSIONS

1:00 – 1:45 p.m.  
**Great Hall**

### GENERAL AVIATION ROUNDTABLE

While all airports are a little different, they face similar issues. This forum allows airport managers and county and city officials to discuss general aviation airport topics of interest and to ask questions in a non-judgmental environment. Chances are good that someone else in the room has experience with your concern and can offer sound advice.

*Moderator: Matt Grenoble, C.M., Airport Superintendent, Sheboygan County Memorial Airport*

1:00 – 1:45 p.m.  
**Rosewood/Linden**

### COMMERCIAL ROUNDTABLE

What is possible? How can we support each other? Join us for a round table discussion on current and exciting topics facing commercial service airports. Come prepared with the ideas, questions, and issues that keep you up at night.

*Moderators: Brian Grefe, A.A.E., Airport Director, Central Wisconsin Airport  
Chris Reis, PE, National Engineering Practice Leader - Aviation, Mead & Hunt*

1:00 – 1:45 p.m.  
**Lawrence**

### AIRPORT BOARD ROUNDTABLE

Being asked to serve on an airport board or commission is a great honor but can be a challenging task. This open roundtable with airport directors, board members, and commissioners is designed to address the issues you've faced and to celebrate the successes you've achieved.

*Moderator: Kurt Stanich, Airport Manager, Waukesha County Airport*

2:00 – 2:45 p.m.  
**Rosewood/Linden**

### STORMWATER RUNOFF FEES

Is your airport located in one of the more than 120 municipalities in the state with a stormwater district? Stormwater runoff fees can have a major impact on your annual operating budget. There are a variety of credits available through most districts. Learn strategies to minimize your fees and ways to alleviate the financial burden of rainfall and snowmelt.

*Speaker: Howard "Buck" Barker, PE, RVT Engineering Services*

*Moderator: Jim Schell, C.M., Airport Director, Wittman Regional Airport*

2:00 – 2:45 p.m.  
**Great Hall**

### SNOW & ICE CONTROL, WINTER OPERATIONS

We all must deal with snow and ice to one degree or another for a large part of the year. This session will provide insight to airport managers, operations/maintenance staff, and contractors on snow removal best practices, tips and tricks, and FAA regulations. Learn the best way to keep your airfield safe during winter events from general aviation and commercial service airport staff.

*Speaker: Kurt Stanich, Airport Manager, Waukesha County Airport  
Emily Whitt, Airport Operations Supervisor, Milwaukee Mitchell International Airport  
David Sweeney, Airport Maintenance Worker In-Charge, Milwaukee Mitchell International Airport*

*Moderator: Matt Grenoble, C.M., Airport Superintendent, Sheboygan County Memorial Airport*

## Thursday, September 21, 2023 [continued]

2:00 – 2:45 p.m.

**Lawrence**

### STATE LEGISLATIVE UPDATE & HOW TO ADVOCATE FOR YOUR AIRPORT

WAMA is working for you in Madison and D.C. Hear about our recent successes and current legislative efforts. We will also learn how to advocate for your airport from a Wisconsin lobbyist.

Speakers:

*Brian Grefe, A.A.E., Airport Director, Central Wisconsin Airport  
Mark Wadium, Outagamie County Lobbyist*

Moderators:

*Charity Zich, C.M., Airport Director, Chippewa Valley Regional Airport*

2:45 – 3:15 p.m.

**Grand Ballroom**

### REFRESHMENT BREAK WITH EXHIBITORS

Haven't hit all the exhibitor booths? Don't worry; you still have time. Turn your passport in by 9:00 a.m. on Friday for a chance to win a \$400 Visa gift card! The winner will be drawn during Friday's morning break.

Feeling charitable and lucky? Purchase 50/50 raffle tickets to support future professional scholarships. Tickets can be purchased at the registration table or at a station in the general session room during breaks. The winners will be drawn during tonight's dinner.

You must be present to win.

*Sponsored by:*

*Midwest Flyer Magazine and MSA Professional Services, Inc.*

## CONCURRENT PROFESSIONAL SESSIONS

3:15 – 4:00 p.m.

**Rosewood/Linden**

### AIP FUNDING CRITERIA FOR MULTIPLE RUNWAYS

Does your airport have more than one runway? Your runways are the lifeblood of your airport but don't assume your crosswind runway is eligible for AIP funding, even if it was built with AIP funds in the past. Learn what it takes to get an eligibility determination from the FAA for your second runway and how Wisconsin airports are wrestling with this emerging capital funding issue.

Speakers:

*Ian Turner, A.A.E., Airport Director, La Crosse Regional Airport  
Jim Schell, C.M., Airport Director, Wittman Regional Airport  
Evan Barrett, AICP, C.M., Manager, Midwest Aviation Planning, Mead & Hunt*

Moderator:

*Mark Cihlar, A.A.E., Assistant Airport Director, Central Wisconsin Airport*

3:15 – 4:00 p.m.

**Lawrence**

### NON-AERONAUTICAL DEVELOPMENT AND THE SECTION 163 PROCESS

Many factors need to be considered when planning for non-aeronautical development at an airport. This presentation will identify these factors and the options for implementing non-aeronautical land uses. As part of the planning process, the applicability of Section 163 also needs to be considered. This presentation will also provide an overview of Section 163 and how airports should coordinate with the FAA to receive a Section 163 determination when planning for non-aeronautical development.

Speaker:

*Zachary Puchacz, C.M., ACE, Airport Planner, Mead & Hunt*

Moderator:

*Terry Donovan, PE, Aviation Project Manager, Mead & Hunt*



## Thursday, September 21, 2023 [continued]

3:15 – 4:00 p.m.  
**Great Hall**

### **BOA POLICY REVIEW & AIRPORT PLANNING INITIATIVES**

*BOA Airport Project Development 101 Session:* Join us for a thorough outline of the Bureau of Aeronautics project development process from when an airport says, "We would like the BOA to get started on our project," to the point the project team says, "Go," to the contractor starting construction. In this session, attendees will learn about the steps involved in planning, design, and bidding, and why initial project planning well in advance is crucial to keep projects on schedule.

*Speakers:* Lucas Ward, Airport Construction Standards Chief, Wisconsin BOA  
Matt Messina, PE, Airport Engineering Section Unit Supervisor, Wisconsin BOA  
Matt Malicki, PE, Airport Engineering Section Chief, Wisconsin BOA

*Moderator:* Melissa Underwood, Senior Aviation Planner, SEH

4:30 – 5:30 p.m.  
**Grand Ballroom**

### **RECEPTION WITH EXHIBITORS**

Grab a drink, network, and show your support for WAC 67 exhibitors by making progress on your exhibitor passport. Turn it in by 9:00 a.m. on Friday for a chance to win a \$400 Visa gift card! The winner will be drawn during Friday's morning break.

Help us support aviation professionals and future scholarships by purchasing 50/50 raffle tickets. This is your last chance. The winner will be drawn at tonight's dinner.

You must be present to win.

*Sponsored by:* **Westwood**

5:30 – 9:00 p.m.  
**Hotel Courtyard and Blaze**

### **NETWORKING EVENT AND DINNER**

Join us for an old-fashioned barbecue and reconnect with friends and colleagues.

Bergstrom Automotive President and CEO Tim Bergstrom will join us to talk about growth and development in today's market. Bergstrom Automotive, headquartered in Neenah, Wisconsin, is one of the top 50 automotive retailers in the U.S.

Drum roll, please! The winner of the WAC 67 50/50 raffle is...

*Sponsored by:* **SEH and Fox Cities Convention & Visitors Bureau**

## Friday, September 22, 2023

7:00 – 8:00 a.m.

### **BREAKFAST WITH EXHIBITORS – Grand Ballroom**

Last chance to complete your exhibitor passport. Get your completed passport in by 9:00 a.m. today. The winner will be drawn during this morning's break. You must be present to win.

*Sponsored by:* **Avfuel Corporation; Cooper Engineering; Crawford, Murphy & Tilly, Inc.; Pro-Tec Fire Services; SP Plus Airport Services; and Veregy**

8:00 – 10:30 a.m.  
**Mahler Boardroom**

### **ONE-ON-ONE "PLANNING ON THE FLY" MEETINGS BETWEEN AIRPORTS, BOA & FAA CHICAGO AIRPORTS DISTRICT OFFICE (FAA ADO)**

This is your opportunity as an airport sponsor to meet with the Chicago Airports District Office (ADO) representatives and the BOA about issues specific to YOUR airport. You must have signed up in advance for an appointment.

## Friday, September 22, 2023 [continued]

## GENERAL SESSION

8:00 – 8:45 a.m.  
Grand Ballroom

### GROWING WISCONSIN AVIATION, SUPPORTING GA EVENTS AND PILOTS AT YOUR AIRPORT

Fly-ins, fundraisers, socials, and other special events engage the community and help your airport succeed. Giving young people a firsthand opportunity to build or fly airplanes can be life changing. Learn how to take a grassroots approach to build a community of supporters around your airport. Our collective passion for flight can inspire people of all ages and ensure that aviation enjoys a vibrant future.

*Speakers:* Larry Sullivan, Founder, Kettle Moraine Youth Aviation  
Jeff Russell, Director, Recreational Aviation Foundation

*Moderator:* Kurt Stanich, Airport Manager, Waukesha County Airport

## CONCURRENT PROFESSIONAL SESSIONS

8:45 – 9:30 a.m.  
Great Hall

### GETTING HANGARS CONSTRUCTED TO ALLEVIATE THE WAITING LIST

Do you have more demand than available hangar space? Is that list ever growing, creating a years-long wait for hangar space at your airport? This national trend is not unique to Wisconsin but is certainly impacting aviation activity in our state. Hear recent success stories and lessons learned. Discover strategies and incentives you can employ to spur hangar growth and revitalization at your local airport.

*Speakers:* Greg Cullen, C.M., Airport Director, Southern Wisconsin Regional Airport  
Jim Schell, C.M., Airport Director, Wittman Regional Airport

*Moderator:* Kurt Stanich, Airport Manager, Waukesha County Airport

8:45 – 9:30 a.m.  
Rosewood/Linden

### AIRPORT ZONING: THE LAST THING ON OUR MINDS

Encroachment of incompatible land uses and obstructions near airports hinder the long-term utility of Wisconsin's airports. State law affords airport sponsors a strong tool to protect critical airport infrastructure. Doing this requires a properly designed and effectively implemented local ordinance, which considers the future, involves the public, and has local support. Many times, airport zoning is forgotten, and encroachment begins to occur. This session is an opportunity to review existing local ordinances, improve them, and discuss how to implement them effectively.

*Speakers:* Hal Davis, C.M., Airport Compliance Program Manager, Wisconsin BOA  
Melissa Underwood, Senior Aviation Planner, SEH

*Moderator:* Ian Turner, A.A.E., Airport Director, La Crosse Regional Airport

8:45 – 9:30 a.m.  
Lawrence

### MARKETING EVENTS FOR COMMERCIAL AND GA AIRPORTS

This session for GA, commercial airports, and FBOs is about how to do a lot with a little to reach your target audience and promote airport events.

*Speaker:* Christina Cole, Senior Digital Aviation Strategist, Advance Aviation

*Moderator:* Brian Grefe, A.A.E., Airport Director, Central Wisconsin Airport

9:30 – 10:00 a.m.  
Grand Ballroom

### REFRESHMENT BREAK WITH EXHIBITORS

This is it – the drawing of the exhibitor passport program winner. Must be present to win.

*Sponsored by:* **DBT Transportation Services, an ADB SAFEGATE Company and Strand Associates, Inc.**

## Friday, September 22, 2023 [continued]

10:00 – 10:45 a.m.  
**Grand Ballroom**

### FIRST F-35 FIGHTER JETS ARRIVE IN MADISON

Join us for the grand finale session of WAC 2023! Our keynote speaker, Colonel Bart Van Roo, Wisconsin Air National Guard's 115th Fighter Wing Commander, will take the stage to share the story behind the design and deployment of the new, 5th generation F-35 fighter to Truax Field at Dane County Regional Airport in Madison. Col Van Roo will explain how the F-35 represents a true paradigm shift in fighter aircraft design and performance. He will explore the F-35's cutting-edge features in-depth, highlighting its groundbreaking capabilities, maneuverability, and state-of-the-art sensor integration.

*Speaker:* Colonel Bart Van Roo, 115th Fighter Wing Commander,  
Wisconsin Air National Guard

*Moderator:* Michael Riechers, Director of Marketing and Communications,  
Dane County Regional Airport

10:45 a.m. **FINAL REMARKS – Grand Ballroom**

*Speakers:* Rachel Engeler, MS, WAMA Past President  
Jim Schell, C.M., WAMA President

11:00 a.m. **EXHIBIT HALL TEAR DOWN – Grand Ballroom**

## WAMA 50/50 RAFFLE BETTING ON WISCONSIN AVIATION'S FUTURE

This year, we have replaced the silent auction with a 50/50 raffle. Please help WAMA provide professional development opportunities to its members and beyond while putting yourself in the running to be the lucky raffle winner.

WAMA is using the proceeds from last year's silent auction to provide scholarships to WAC 67 and the organization's first-of-its-kind class, the Basics of Airport Management Seminar, made possible by presenting sponsors Mead & Hunt and Westwood.

The WAMA board aims to get more people educated about and engaged in Wisconsin aviation. You play a crucial role simply by attending WAC 67 and welcoming first-time participants.

On Thursday, purchase your tickets at the registration table or a station in the general session room during breaks. The winner will be drawn during Thursday's dinner.

You must be present to win.



**1200.aero**

Operations tracking and aviation safety for airports, FBOs, and flight schools. Fly by the numbers!

**Booth 2****Advance Aviation**

Advance Aviation is a full-service airport marketing partner focused on decreasing leakage while increasing enplanements and passenger retention nationwide. Our vast airport industry knowledge and full-scale marketing services enable us to help our airport partners with their challenges and goals. We focus on increasing community engagement for those who could and should fly local, helping increase enplanements and load factors, which are vital for attracting new service.

**AECOM**

AECOM is planners, designers, engineers, consultants, and program and construction managers — delivering professional services spanning cities, transportation, buildings, water, new energy, and the environment. Working throughout the project lifecycle, we're one team driven by a common purpose to deliver a better world.

**Airport Lighting Company****Booth 15**

At Airport Lighting Company, airfield lighting is our only business. Our extensive inventory of products includes approach lights & navigation aids, power & control equipment, elevated lights, guidance signs, and much more. We guarantee fast shipping, and most orders will be shipped the same day. Airport Lighting Company also provides access to professional product managers and free expert technical support from our highly experienced team.

Whether you're planning a lighting upgrade, or maintaining an airport's legacy system, we'll help you do your job on time and on budget.

Airport Lighting Company: Your first choice for airfield lighting equipment.

**Appleton Flight Center**

Wisconsin's premier FBO serving Appleton International Airport (ATW).

**Applied Pavement Technology, Inc.**

With more than 25 years of pavement engineering expertise, Applied Pavement Technology Inc. delivers tailored solutions that meet client needs. Whether we're completing your next pavement engineering or management project, conducting pioneering research with the FAA and other research teams, and developing industry-leading tools like IDEA, we have the skill—and passion—to exceed your expectations.

**Arrow Energy, Inc.****Booth 24**

We are a wholesale provider of aviation fuels. We represent the Phillips 66 brand and are focused on the Great Lakes Region.

**Avfuel Corporation**

Avfuel Corporation is focused exclusively on aviation. We continue to solicit and incorporate the insight of pilots, flight departments, and FBOs as we add and adapt our offerings. We're not in the business of simply selling fuel and services — we're in the business of connecting people, companies, and cultures.

**The Aviation Planning Group**

The Aviation Planning Group (APG) is a majority-woman-owned collaborative aviation consulting firm focused on serving as an extension of staff to airports and aviation businesses of all sizes, providing quality environmental, planning, design, and construction management services. They seamlessly partner with airports and aviation businesses to plan for their future, sustain compliance, accommodate demand, and design and provide construction management for the maintenance/replacement of infrastructure using private, local, state, and federal funds. Partnered with Volatus Infrastructure, APG performs vertiport and alternative fuel planning, siting, and design for advanced air mobility. As former airport managers, state aviation staff, and active pilots, we understand the challenges airports face. APG's technology division offers web application solutions to support airport managers in managing their hangar wait lists and leasing, as well as other digital media solutions.

**Becher Hoppe Associates, Inc.****Booth 6**

Improving communities. Becher Hoppe provides professional planning, design, and construction services serving communities throughout Wisconsin. Airports, highways, water and wastewater systems, municipal utilities, storm water management, real estate appraisal and acquisition, mapping, and dams. Engineering excellence, award-winning projects, improving communities.

**Benesch**

Serving a broad range of markets, Benesch has played a role in shaping our nation's infrastructure and local communities for decades. We are client-focused, dedicated to providing responsive service and recruiting the very best talent to deliver project success.

With 1,000 employees—including engineers, landscape architects, scientists, construction managers, surveyors, and planners—in 47 locations across 20 states, we are united in our commitment to quality professional services.

**Burns & McDonnell**

Burns & McDonnell's mission is to "make our clients successful." We do so by providing exceptional full-service engineering, design, and construction. Our company has proven industry-leading success in developing terminals, airfields, landside, support and fueling facilities in the United States and around the world.



**CBS Squared, Inc.****Booth 20**

CBS<sup>2</sup> was established in Chippewa Falls, Wisconsin, in 2011 by four individuals with a passion for engineering and architecture. CBS<sup>2</sup> now employs almost 90 individuals across six offices in Wisconsin & Minnesota. Our mission is to positively impact communities and the environment by providing clients exceptional architectural, engineering, survey, and construction management & oversight services.

At CBS<sup>2</sup>, we believe collaboration between employees and clients throughout the entire process produces the best results. We know the project may end with construction, but it starts with unparalleled planning, design, and communication with clients, stakeholders, and consultants. Our dedicated and multi-disciplined professionals strive to provide results that exceed expectations.

CBS<sup>2</sup> has over 30 years of combined experience in airport project design, including staff who are licensed pilots and offer end-user perspective during design. We deliver a full range of quality services with a focus on superior service to local, regional, state, and federal agencies as well as industrial and private-sector clients.

**Century Fence****Booth 13**

We are a commercial fencing company as well as a highway striping company. We have been in business for over 105 years.

**Coffman Associates**

Coffman Associates is a full-service airport planning firm specializing in airport master planning, noise and land use compatibility planning, environmental documentation, sustainability planning, and airport-friendly AGIS applications. We work only for airports, with our focus on objective and innovative planning for your success.

**Cooper Engineering**

Founded in 1950 in Rice Lake, Wisconsin, Cooper Engineering is a multi-disciplined civil/environmental firm. We provide engineering to the public, commercial, and industrial sectors. We have provided airport clients with sound planning and engineering services for over 30 years. We share your passion for flying and serving the traveling public.

We look forward to meeting you or getting to know you better. Thanks for attending/supporting the 67th Wisconsin Aviation Conference. Brad Volker, 715-234-7008, bvolker@cooperengineering.net

**Crawford, Murphy & Tilly, Inc.**

Full-service aviation consultancy.

**DBT Transportation Services, an ADB SAFEGATE Company**

DBT Transportation Services, an ADB SAFEGATE Company, provides field maintenance services in North America for Non-Fed Automated Weather Observation System (AWOS), NAVAIDS, control towers, airfield lighting and Runway/Roadway Weather Information Systems (RWIS). Specializing in remote maintenance monitoring and customer designed maintenance programs, DBT's focus is enhancing customer operational efficiencies by ensuring high uptime of equipment. The company tagline is "Doing Business Together" and is built on the belief that providing long term partnerships with our customers is the key to our success.

**Diaz Group LLC****Booth 14**

Commercial landscape and snow removal.

**Endpoint Solutions**

Engineering consulting firm offering a combination of traditional and specialized design, environmental, health and safety consulting services, including the design of aviation fueling systems.

**EPIC Fuels****Booth 4**

EPIC Fuels, a Signature Aviation company, is a trusted supplier of fuels and services to FBOs, commercial airlines, airports, ground fueling operators, the U.S. Defense Logistics Agency (DLA), and other government agencies around the world.

Our largest customers include Fortune 500 flight departments, top-tier FBOs, major airlines, charter and cargo operators, as well as all branches of the U.S. military.

Additionally, the company offers payment card and transaction processing solutions for the fueling industry. The EPIC Card, the company's proprietary aviation fuel card for retail or contract fuel purchases and ancillary services, is accepted both in and out of network at over 8,000 locations. EPIC Fuels also provides state-of-the-art self-serve fueling terminals through QTpod, its Longmont, Colorado-based subsidiary. For more information, please visit us online at [www.EPICFuels.com](http://www.EPICFuels.com).

**Fahrner Asphalt Sealers, LLC****Booth 5**

Full-service asphalt maintenance with over 40 years of experience. Crack sealing, chip sealing, line painting, infrared patching, hydro-blasting, airfield marking, and special services.

**The Green Earth Deicer Company, Inc.****Booth 28**

Environmentally friendly deicers for runway and non-airside applications.

**Hali-Brite, Inc.****Booth 21**

Industry leader in the manufacturing of FAA certified wind cones, rotating beacons, tipdown towers and runway closure markers.

**Halliday Technologies**

Halliday Technologies FAA-approved, USA-built, RT3® Flight Friction Tester enables airport staff to accurately measure any runway or taxiway surface friction with repeatable results. The RT3 data will guide Operations when it is necessary to treat surfaces to increase friction, whether in winter to remove snow and ice or in summer to remove rubber build-up.

The RT3 Flight is extremely easy to use, with accurate, repeatable, and reliable results. Operations can measure surface friction quickly and efficiently, minimizing runway downtime. The output is easy to interpret so that treatment decisions can be made quickly.

Halliday Technologies has been designing and manufacturing friction equipment for over 20 years. Our Wisconsin customers include Chippewa Valley Regional Airport, Central Wisconsin Airport, Appleton International Airport, Wittman Regional Airport, and Dane County Regional Airport. We serve 57 customers globally and are the leading friction tester chosen by the US Military.

**Helena Agri-Enterprises****Booth 9**

We provide vegetation management solutions and products for airports and municipalities.

**HUB Parking/TIBA Parking**

HUB and TIBA, brands of FAAC Technologies, provide world-class products with the highest quality and value-driven solutions in the Smart Parking Industry. Our innovative parking solutions enable a seamless parking experience for drivers and will improve your operations' efficiency. Our state-of-the-art platforms enable free-flow access, mobile and LPR recognition to minimize touch interaction, cloud-based parking, and EV-charging technology integration to future-proof your parking asset.

**Interflight Parking****Booth 29**

Interflight Parking Company facilitates the development and deployment of advanced parking solutions to address the unique challenges of airport parking operations. Interflight is solely focused on delivering a fresh combination of smart technology, unparalleled customer service programs, and proven operating techniques tailored specifically for airport parking systems.

Interflight Parking Company has the largest airport parking management team in Wisconsin. As the sole parking operator for Milwaukee Mitchell International Airport and one of Milwaukee's largest parking operators for downtown parking, we have extensive Wisconsin-based experience and knowledge. Interflight Parking and its partners are 100% Wisconsin based. We believe our success is tied to the success of the communities we serve, and we are proud to support local businesses and organizations. Our executive, senior management, and support teams live, raise families, work, and travel here in Wisconsin. That sense of hometown pride has us thrilled to have the opportunity to deliver the absolute best client and customer experience to our friends and neighbors.

**Jviation, a Woolpert Company**

Jviation, a Woolpert Company, is a planning, engineering, architecture, survey, and construction administration firm that focuses on aviation-related projects. Jviation provides airport clients, from general aviation to commercial service facilities, with comprehensive consulting services in order to best serve the airport's unique needs

**Keller, Inc.****Booth 12**

Keller, Inc. is a design/build general contractor located in the Fox Cities with additional offices in Milwaukee, Madison, and Wausau. With an on-staff team of architects, interior designers, and project managers, we are a single point of contact for our customers to keep everything on track, on time, and within budget.

**Leibowitz & Horton Airport Management Consultants, Inc.**

With offices in Denver, Atlanta, and Houston, Leibowitz & Horton Airport Management Consultants, Inc. provides financial consulting services to more than 110 commercial service airports. Our experience includes financial planning, rates & charges, airline/tenant negotiations, financial feasibility studies, PFC and CFC implementations, and FAA BCA and funding assistance. We provide experienced staff who understand airports, deliver what we promise, and concentrate on what we do best.

**MacQueen Equipment****Booth 1**

MacQueen is proud to offer the highest quality environmental and emergency products and services with a "Service First" mentality to municipalities, contractors, airports, and fire departments in the Midwest. When you choose to work with MacQueen, you're not just buying an apparatus or a piece of equipment; you are buying into the MacQueen Way – full product, parts, and service support for the lifetime of your equipment.

**M-B Companies****Booth 32**

World leader in providing amazing snow removal equipment to airports around the globe.

**Mead & Hunt****Booth 18**

Mead & Hunt is a full-service aviation consultant providing expertise in engineering, planning, architecture, environmental, air service, sustainability, noise, wildlife, financial planning, and program management. We have been active in airports since the 1940s, serving a national audience with a local perspective. Consistently placing in Engineering News Record's "Top 25 in Airports" list.

**METCO, Inc.****Booth 7**

METCO is a full-service fuel system provider.

**Midland Door Solutions/Foremost Buildings****Booth 3**

Midland Door Solutions manufactures and installs bifold and single-piece hydraulic doors. Foremost Buildings manufacture pre-engineered metal buildings. Midland Door Solutions and Foremost Buildings work together to supply a high quality building and door package.

**Midwest Flyer Magazine**

Dave and Peggy Weiman founded "Wisconsin Flyer" magazine in 1978, renamed the publication "Midwest Flyer Magazine" in 1980, and expanded the area served from one to 12 Midwestern states, including Wisconsin, Minnesota, North Dakota, South Dakota, Iowa, Nebraska, Kansas, Missouri, Illinois, Indiana, Michigan, and Ohio. Readers consist of airport managers, aviation businesses, pilots, and aircraft owners <https://midwestflyer.com/> Awards: "Blue Light Award" (WAMA 1981 & 2005), "National Journalism Award" (NASAO 2010), "AOPA Presidential Citation" (2003), "Aviation Business of the Year Award" (WATA, 2000 & 2009), "Award of Excellence" (MCOA, 2004).

**MSA Professional Services, Inc.****Booth 22**

MSA is a 100% employee-owned team of engineers, architects, planners, funding and GIS experts and environmental scientists specializing in the sustainable development of communities. We build project teams based on the specific needs of our clients, collaborating as needed across state lines and with local, state, and federal agencies and organizations to ensure projects are smart, efficient and cost-effective.

**Nielsen Madsen + Barber**

Nielsen Madsen + Barber is a full-service consulting civil engineering and land surveying firm providing expertise in civil engineering and design, planning and development, surveying and mapping, municipal engineering, water resources, and construction services for over 69 years.

**NV5 Geospatial****Booth 11**

NV5 Geospatial is an industry leader in FAA AC 150/5300 airport mapping solutions. We've mapped more than 750 airports under the latest FAA guidelines, including dozens of eALPS and the first eALP to be approved by the FAA. We offer technical excellence and superior service for all of your airport mapping needs.

**ProSource****Booth 10**

With personalized, responsive service and years of invaluable experience, ProSource's staff offers unique and affordable project solutions. ProSource provides its clients with the essential services to help public and private projects move forward in compliance with federal, state, and local laws. ProSource's experienced staff has gained a reputation for being knowledgeable, innovative, and resourceful with a genuine concern for the client's needs.

Our company's professionals include licensed real estate brokers, agents, attorneys, and abstractors who are highly knowledgeable and experienced in the route analysis, title standards, and permitting requirements of federal, state, and local agencies. ProSource's staff also includes specialists in acquisition, relocation, title, appraisal, environmental permitting, database management, geographical information systems (GIS), disaster and emergency management, and site selection and project development.

**Pro-Tec Fire Services****Booth 25**

Pro-Tec Fire Services, a family owned business, is the premier North American leader in contracted Aircraft Rescue Firefighting (ARFF), providing services to commercial airports, airparks, and aircraft manufacturers. We have exemplary experience. Beginning in 1974, we now serve 24 customers in the United States and Canada, many of which we have supported for more than 20 years. Our company's reputation is built on the solid, long-term professional relationships we've worked hard to build along the way. We are proud of the superior performance put forth by our professional staff.

Pro-Tec Fire Services provides extensive classroom and hands-on ARFF training courses delivered by experienced ARFF officers using lesson plans compliant with applicable FAA Advisory Circulars and National Fire Protection Association standards. A core tenet of our organization is safety, which is reflected in our experience and our exceptional eMod rate (worker's compensation) of .60 companywide.

**SEH****Booth 30**

Our 800-plus employee-owners share a core purpose: Building a Better World for All of Us®. This approach reflects a company-wide commitment to improving the quality of life by designing safer, more sustainable infrastructure for government and helping industrial and commercial clients achieve their business goals.

**Sherwin Industries, Inc.**

Distributors of asphalt pavement maintenance supplies and airport/airfield safety products.

**SP Plus Airport Services**

SP+ sets itself apart in the industry by managing our airport operations through a dedicated Airport Services division with over 65 years of airport-specific parking experience. Airport services include parking management, shuttle buses, valet, curbside management, Bags Aviation, parking reservations, and Sphere, a cloud-based parking management system supporting all B2C payment solutions.

**Strand Associates, Inc.**

Established in 1946, we are a dynamic, multidisciplinary engineering firm serving the needs of public and private sector clients throughout the USA. We have 12 offices across the country, including Arizona, Illinois, Indiana, Iowa, Kentucky, Ohio, Tennessee, Texas, and Wisconsin. Our Aviation services include plan development, design, and construction management for more than 50 General Aviation (GA) airports.

**TITAN Aviation Fuels**

TITAN Aviation Fuels is one of the largest suppliers of aviation fuel products in the United States. Our FBO network is 600+ FBOs strong. In addition, we serve airlines, corporate flight departments, and aerial applicators. TITAN Aviation Fuels is strategically aligned with major refiners to bring its customers a secure supply, and clean, high-quality fuel. With nearly five decades of experience in aviation fuels and related services, TITAN knows what it takes to succeed. Our focus has always been on our FBOs and providing the tools to help your business grow. Going far beyond just fuel, TITAN has the tools to fuel your success. A professional "flying" aviation sales staff assures top-notch, highly personalized customer service and a greater understanding of your FBO business. We provide a high level of quality service and consider our customers to be our partners. You will not find this level of service anywhere else in the aviation industry.

**Booth 17****TKDA**

TKDA is a 100 percent employee-owned engineering, architecture, and planning firm established in 1910. As a multi-discipline firm, TKDA is committed to providing sustainable design services that build upon our tradition of delivering trusted solutions and creating value for our clients, communities, and employees. Our aviation team consists of 40+ professionals solely committed to airport planning, design, and construction engineering services. We are passionate about aviation and delivering the highest standards of excellence to each of our general and commercial aviation clients across Wisconsin and the United States. [www.tkda.com](http://www.tkda.com)

**Booth 26****UW Oshkosh Online and Continuing Education**

UW Oshkosh's online Bachelor of Applied Studies in Aviation Management program prepares you to move into an advanced position and become an industry leader.

With a focus on developing advanced skills in leadership and administration, your Aviation Management degree builds upon your professional and educational aviation experience.

Coursework integrates aviation law, airline production management, and analysis methods for aviation and aerospace systems.

**Veregy**

Veregy is an award-winning engineering and energy service company that creates pathways to eco-friendly building and systems optimizations, generating immediate and future energy savings. Veregy is an industry leader in energy efficiency solutions, solar, and smart building technology. We believe innovation — together with unparalleled service — creates the most long-term value for our clients. Veregy's experienced and dedicated team develops and delivers customized strategies to resolve our client's facility challenges, while optimizing building performance and reducing energy consumption.

**Booth 27****Westmor**

Regardless if you're running a smaller FBO (fixed-base operator) or a larger into-plane operation, the equipment needed to operate your aviation business can be complicated. Our team has over 40 years of experience in the aviation industry, providing you with the consistent support you need.

Westmor can spec and build custom equipment for your operation. And, because we're from Minnesota, we can recommend some of the best cold-weather equipment options available.

**Booth 31****Westwood**

Established in 1972, Westwood is a full-service, multi-discipline professional engineering firm providing services to public and private clients. Westwood is committed to successful and long-lasting client relationships. We set clear objectives, streamline processes, and utilize employee talents to meet project demands. We understand that project delivery is achieved through a structured process that requires all phases of project management to execute them successfully. Yet we are flexible enough to deal with changes as they arise. Our staff is effective at implementing strategies, tactics, and tools that provide added value. Our experience, combined with significant success representing our clients, gives meaning to our Mission Statement: Solutions for Your Success!

**Booth 16****Wisconsin Concrete Pavement Association****Booth 8**

The members of the Wisconsin Concrete Pavement Association (WCPA) are Wisconsin-based contractors, cement and ready-mix producers, manufacturers, and suppliers.

WCPA has represented members to industry and the public since 1952. We are recognized as the voice of the concrete pavement industry in Wisconsin. Our office in Madison allows close communication with the DOT.

Members receive ongoing communication about the concrete industry through this website, social media, e-mail updates, and in-person events.



**Wisconsin Surplus Online Auction****Booth 23**

Wisconsin Surplus is a family-owned business with a long history in the auction industry based in Mount Horeb, Wisconsin. We enjoy a respected name and reputation for providing professional, full-service, online auction solutions. Wisconsin Surplus owners, Richard & Matthew Lust, (Father & Son) have been auctioneers since 1975 and 1993, respectively. In 2003, WisconsinSurplus.com was established as the online division of our 44+ year-old auction company when we secured the contract to be the online auction provider for the State of Wisconsin.

We are dedicated to selling surplus assets for states and municipalities via online auction. Over the past 16+ years, Wisconsin Surplus has conducted thousands of auctions for hundreds of state and local government agencies, municipalities, educational institutions, businesses, and the general public in Wisconsin, Illinois, Michigan, Iowa, and Minnesota. We offer auctions at the seller's location or the use of our auction sales lot and warehouses in Mount Horeb.

The owners and staff of Wisconsin Surplus are proud to call Wisconsin our home. We take great pride in offering an efficient way of turning unused equipment and surplus property into cash. Bringing sellers and buyers together enables the sustainable reuse and repurposing of unneeded assets. Our buyers are pleased to find what they need, and our sellers can use their auction proceeds for new items.

**World Fuel Services****Booth 19**

At World Fuel Services, we deliver competitively priced fuel, a complete line of deicing products, and aviation solutions to support more than 900 FBOs and airport locations in North America. Our dedicated team and suite of industry-leading products provide you with more value than any other supplier. Whether we're helping customers meet operational performance goals or investing in programs to help drive growth, we deliver solutions that go beyond fuel.



Photo by Hal Davis  
[haldavisphotography.com](http://haldavisphotography.com)

**AVIATION  
MANAGEMENT**  
 BACHELOR OF APPLIED STUDIES

**UWO**  
 UNIVERSITY OF WISCONSIN  
 OSHKOSH

OCE@UWOSH.EDU • (920) 424-0234
 UWO.SH/AVIATION

**PREPARE YOUR  
AIRPORT FOR  
TAKEOFF.**

The right flight plan starts with the right parking solution.

- No Fixed Management Fee
- 100% Client Retention
- First Class Traveler Experience
- Customized Parking Solutions
- Data Analytics

Visit [Interflightparking.com](https://Interflightparking.com) to learn more!

## Aviation Services

Airfield Lighting and NAVAIDs  
 Airside Design  
 ALPs and ACIP Planning  
 Construction-Related Services  
 Environmental  
 Facility Extensions/Expansions  
 Hangars and Fuel Farms  
 Landside Improvements  
 Pavement Reconstruction/Rehabilitation  
 Perimeter Fencing



[www.strand.com](https://www.strand.com) | 608.251.4843



# **RIM PROGRAM REFRESHER**

## **FROM ITS HISTORY TO THE HORIZON**

In 2013, the FAA started the Runway Incursion Mitigation (RIM) Program. The RIM program was launched with the goal of reducing runway incursions by eliminating RIM geometries over the planned 15-20 year improvement program. The first phase was to do a research study that identified and located nonstandard taxiway geometry associated with runway incursions. The next phase of implementing mitigation measures began in 2015.

The FAA defines runway incursions as “any occurrence at an aerodrome involving the incorrect presence of an aircraft, vehicle, or person on the protected area of a surface designated for the landing and takeoff of aircraft.” This definition includes wrong runway landings and takeoffs. The FAA developed an inventory of RIM locations from the original study. Inventory updates continue as additional data becomes available. The inventory is based on nonstandard taxiway geometry associated with a high incidence of runway incursions.

These nonstandard taxiway geometries, known as problematic taxiway geometry locations (PTGs), have been categorized into 19 different types. The three types of PTGs associated with the highest number of runway incursions are:

- Short taxi distances from a ramp/apron area to a runway – Short distances provide less time for a pilot to complete their preflight checklist. As a result, the pilot may lose situational awareness and taxi through the hold line.
- Direct taxiing access to runways from a ramp area – Here, pilots may expect a parallel taxiway prior to the runway. This expectation can lead to runway incursions.
- Taxiways intersecting a runway at other than a 90-degree angle – Right-angle intersections provide the Pilots with the best view of the runway intersection as they are approaching. The reduction of visibility from other configurations can contribute to runway incursions.

Currently, more than 6,600 geo-located PTGs are in the system. Of those PTGs, 216 have been validated and added to the inventory as RIM locations. Any location where three or more runway incursions occur in a single calendar year, or an average of one or more have occurred in the most recent ten years, will be considered for inclusion in the RIM program. On average, nearly 16 new RIM locations are added to the inventory annually.



In 2015, the FAA began to formally act on the research study results. Through RIM, as of May 2023, 93 locations have been mitigated. These mitigations have eliminated 25 hot spots from airfield configurations at various locations around the country. Some of the mitigation measures are simple procedural updates or airfield marking changes. At other times, the mitigation required is more significant, such as taxiway reconfiguration or threshold relocation. At former RIM locations with at least one year of post-mitigation runway incursion data, the FAA has found a reduction average of 78 percent in runway incursions after mitigation.

Annual summaries released every year since 2018 are available on the FAA's RIM Program web page ([www.faa.gov/airports/engineering/incursions\\_excursions/rim](http://www.faa.gov/airports/engineering/incursions_excursions/rim)). According to the FAA, the current RIM inventory includes 123 locations, of which 106 are associated with a current capital project, including 18 in construction, 16 in design, and 72 in the planning stage. Seventeen locations are waiting to get underway with the mitigation and planning phase of the program.

According to the FAA's inventory, the Great Lakes Region has eight documented RIM locations, none of which are within Wisconsin. So, how does all of this affect the aviation industries in Wisconsin? There have been an average of 16 runway incursions every year since 2019 (2020 data was not included in this average since traffic levels were impacted by Covid). Although there aren't currently any RIM locations identified on airports in Wisconsin, runway incursions are happening at towered airports across the state at a rate greater than once a month.

While runway incursion data is not monitored as stringently at nontowered airports within the state, they very likely happen there as well. The severity of incursions varies – a serious runway incursion could cause a collision, making it one of the most dangerous events that can happen on an airport. The RIM Program has provided data that can be applied to improve safety at both towered and nontowered airports, even if runway incursions are not being recorded. If any of these scenarios occur at your airport and you would like to discuss appropriate mitigation options to improve safety for your users, stop by the Mead & Hunt booth. We would be happy to start the conversation.

Krista Hager, PE and Terry Donovan, PE  
Project Manager, Aviation Engineering



Mead & Hunt, Inc.

2018



2022







Price County Airport



Central Wisconsin Airport



## Airport Services

Planning | Design | Real Estate  
Construction Services | Surveying  
Drone Imagery and Mapping

[becherhoppe.com](http://becherhoppe.com)



Contact: Karl Kemper, PE | [kkemper@becherhoppe.com](mailto:kkemper@becherhoppe.com) | 715-551-5507



**FUELING SUCCESS SINCE 1975.**

**TITAN  
DELIVERS**

With nearly five decades of experience in aviation fuels and related services, TITAN knows what it takes to succeed. Our focus has always been on you and providing the tools to help your business grow. Going far beyond just fuel, TITAN has the tools to fuel your success.

[www.titanfuels.aero](http://www.titanfuels.aero) • 1-800-334-5732

Bill Kovac, Midwest Sales Manager • 262.902.8682

# WAMA REGIONAL CHAPTER PROGRAM ENTERS SECOND YEAR

The regional chapter program, initiated in 2022, allows WAMA airport members to get together in person more than once a year at the Wisconsin Aviation Conference and share common challenges, ideas, and success stories. These meetings are geared toward industry veterans and newcomers alike. Each chapter leader periodically contacts the members to schedule a meeting outside the annual conference timeframe. These additional interactions are intended to promote information sharing and strengthen the Wisconsin airport management community.

## Northwest Chapter

The Northwest Regional Chapter met on May 10th at the New Richmond Airport. East Metro Jet Center graciously allowed the use of its facilities for the meeting. WAMA legislative efforts, airport recruiting and retention, airport projects, and fueling were among the many topics covered during the roundtable discussion.

Regional Leader: Charity Zich (EAU)  
charity.zich@chippewavalleyairport.com

## Northeast Chapter

The Northeast region will begin coordination after WAC 2023 to plan their next regional meeting.

Regional Leader: Mark Cihlar (CWA)  
mcihlar@fly-cwa.org

## East Central Chapter

The East Central region convened its meeting on May 23rd at the Manitowoc County Airport. Six regional member airports were in attendance, and a spirited discussion ensued. One central talking point was working with your municipality or sponsor to educate them on what your airport is doing regularly, the long-term goals, and the most effective form of governance.

Regional Leader: Jim Schell (OSH)  
jschell@winnebagocountywi.gov

## Southeast Chapter

The Southeast region last met at the Dane County Regional Airport in March. Kim Jones, the airport director, did a great job hosting. There were a variety of airport issues discussed. One popular idea was to incorporate a future meeting at the state Capital, perhaps in conjunction with WAMA's annual legislative day event. Region Chair Greg Cullen stated, "I think the most value-added part of the meeting for me is putting a name with a face. We see other airport manager names listed in a directory, but it's nice to meet in person and share stories."

Regional Leader: Greg Cullen (JVL)  
Greg.Cullen@co.rock.wi.us

## Southwest Chapter

The Southwest region plans to host its next meeting in early 2024.

Regional Leader: Ian Turner (LSE)  
turneri@lseairport.com

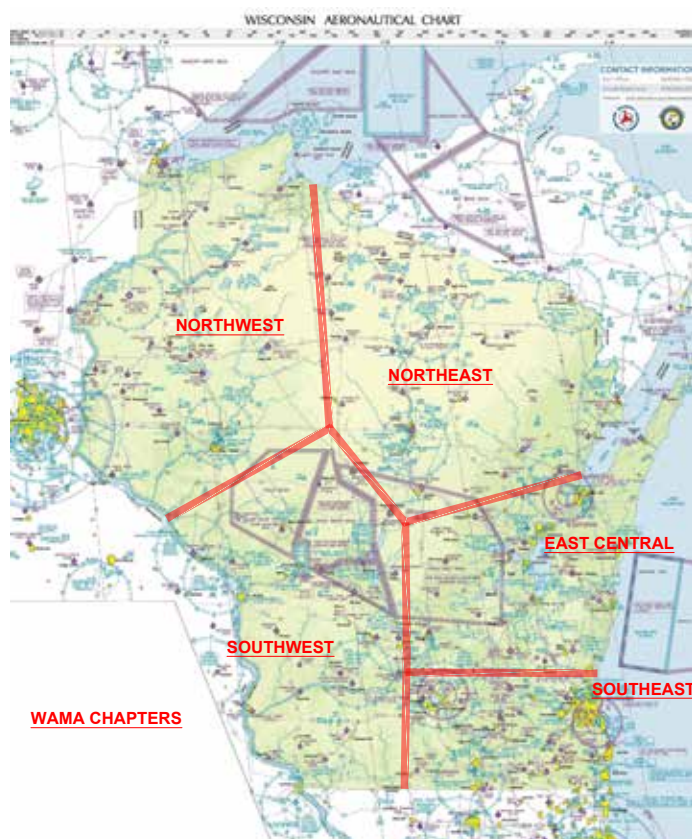

Don't hesitate to contact your chapter leader or any WAMA board member if you need a sounding board, advice, or want to get more involved in the organization. ➔

Jim Schell, Airport Director,  
Wittman Regional Airport (OSH)



# COLLEGE FLYING COMPETITION LANDED IN OSHKOSH IN 2023

Wittman Regional Airport in Oshkosh hosted the National Intercollegiate Flying Association (NIFA) SAFECON competition for the first time in May 2023. It marked only the second time NIFA held this national competition in the state. Janesville hosted SAFECON in 2019 and is slated to host it again in 2024.



SAFECON is the premier collegiate aviation competition in the country. Over 400 competitors from 28 schools competed this year to the delight of about 700 attendees, including judges and support staff. Young pilots from across the country competed for awards in various aviation skills, including landing, navigation, preflight, flight planning, crew-based simulations, safety, sportsmanship, and more.

The flying portions of the competition were launched and recovered from Runway 18/36 at OSH. NIFA ran the ground-based events at EAA facilities adjacent to the airfield. These young pilots executed spot landing, navigation, and message drop events flawlessly, and by all accounts, NIFA's annual flagship competition was a huge success. ➔

For additional information visit [NIFA.aero](http://NIFA.aero)  
 Jim Schell, Airport Director, Wittman Regional Airport (OSH)



## WE CUSTOM DESIGN & INSTALL DOORS

FOR YOUR NEW OR EXISTING HANGER

[MIDLANDDOORSOLUTIONS.COM](http://MIDLANDDOORSOLUTIONS.COM)
[FOREMOSTBUILDINGS.COM](http://FOREMOSTBUILDINGS.COM)

**ADVANCE**  
 AVIATION  
 Proud Sponsor of the  
 67th Wisconsin Aviation Conference

### A Full Service Airport Marketing Partner

focused on communicating the right message at the right time to reach your target audience and decrease leakage while increasing enplanements, passenger retention, and commitment to fly local.

Experienced Aviation Experts

Proven Marketing Tactics

Award-Winning Creative

A marketing partner with more

[AdvanceAviationMarketing.com](http://AdvanceAviationMarketing.com)

# MAXIMIZING THE AIRPORT TERMINAL PROGRAM FUNDS: A NEW OPPORTUNITY FOR GENERAL AVIATION AIRPORTS



Proactive airport planning, stakeholder engagement, and understanding the federal grant process are a few key elements that helped four SEH general aviation (GA) airport clients secure the Airport Terminal Program (ATP) funding in 2022 and 2023.

Signed into law in November 2021, the Bipartisan Infrastructure Law (BIL) provides \$20 billion of federal funding over the next five years for airport sponsors to use on projects that are eligible and justified. This includes such facilities as runways, taxiways, safety and sustainability projects, and terminals. Within this law, there are multiple pots of money available, one of which is the Airport Terminal Program. Through the ATP, airport sponsors can apply and compete for a grant from the FAA for up to 95% of the eligible costs of a terminal building.

Typical FAA funding focuses heavily on safety-critical items and airside pavement maintenance, putting funding to replace aging terminal building infrastructure at a lower priority. The ATP funding now provides airports the much-needed opportunity to fund terminal improvements that expand capacity, increase energy efficiency, promote competition, and improve accessibility.

Three of SEH's clients were selected for the first round of ATP funding in 2022\*, and one client was selected for 2023 ATP funds. The four communities include Glencoe, Minnesota; Fillmore County, Minnesota; Chamberlain, South Dakota; and Duluth, Minnesota. These airports support recreational, business, corporate, agricultural, and medical aviation purposes in rural and metropolitan areas.

Each year, most of the FAA Airport Improvement Program Entitlement funding for these airports has been focused on pavement maintenance and any needed safety improvements. As a result, the funding often does not reach public buildings such as terminals. Terminal buildings include restrooms, weather stations, pilot planning rooms, waiting/resting areas, and vending opportunities for pilots, passengers, and community members to use while at the airport. Most buildings have not been updated since constructed

in the 1970s or 1980s, and the buildings often do not meet all ADA requirements and are not energy efficient. Receiving funding from the ATP allows these communities to improve this important infrastructure.

From the implementation of their updated Master Plans and Airport Layout Plans, to their Capital Improvement Program planning, these four successful communities were ready to apply for this funding and take advantage of the opportunity at this ideal time.

## General Considerations

To apply for an ATP grant, you need to consider several key items, as managing the timeline and expectations can be complicated. Below are a few key items to consider when evaluating if this funding source is appropriate for a terminal project at your airport.

- The project must be shown on an approved Airport Layout Plan, and the project need should be documented in your Master Plan.
- All terminal projects will need an environmental review prior to construction. Typically, a Categorical Exclusion (CatEx) can be used for the environmental review. Field work may be necessary to determine nearby wetland boundaries or to complete an architectural history assessment.
- FAA Buy American requirements (49 U.S.C. § 50101) apply to construction of a new building at an airport.
- **To meet ATP grant deliverable timelines, sponsors need a proactive and strategic approach to ensure they can meet the deadlines. This may require the airport sponsor to have a design consultant selected and under contract. For example, in 2023, sponsors were notified of grant awards in late February and were expected to have the project bid by July 1.**



## Funding Eligibility

Another key element to consider is funding eligibility. It is important for airport sponsors to manage expectations and understand what items within a terminal building are eligible for federal funding and which items are not.



A terminal building at an airport is a public-use facility that passengers may need to occupy as part of their air travel. Minor rehabilitation or remodeling of a terminal building is not eligible for federal funding. However, major rehabilitation (creating an additional useful life of 40 years), replacement and new construction are eligible for FAA funding.

Not all spaces that are often included in a terminal building are eligible for FAA funding. Ineligible costs are tracked separately and must be paid for with sponsor or other non-FAA funding sources. The table below includes examples of items that are eligible and ineligible for FAA funding in a terminal building project.

Coordination with the FAA Program Manager is important when discussing the eligibility of a new terminal building, including the components inside the building. When considering eligibility, ask yourself, "Is the space or item essential for pilots and passengers of the building?"

The next ATP funding cycle begins soon. Keep an eye on the FAA's ATP Website ([www.faa.gov/bil/airport-terminals](http://www.faa.gov/bil/airport-terminals)) for the upcoming Notice of Funding Availability ([www.federalregister.gov](http://www.federalregister.gov)) for FFY 2024, and be sure to take note of funding eligibility requirements. The FAA published the rating criteria in the Notice of Funding Availability, which include:

- Meeting eligibility requirements
- Timeliness of implementation, with priority given to projects that can satisfy all requirements for grant award in FFY 2024
- Favorable consideration for projects that:
  - Increase capacity and passenger access
  - Replace aging infrastructure
  - Achieve compliance with the ADA, including expanding accessibility for persons with disabilities
  - Improve energy efficiency, including upgrading environmental systems, upgrading plant facilities, and achieving Leadership in Energy and Environmental Design (LEED) accreditation standards
  - Improve airfield safety through terminal relocation
  - Encourage actual and potential competition



For questions or additional information, please contact the SEH aviation team at the conference, or:

Melissa Underwood  
[munderwood@sehinc.com](mailto:munderwood@sehinc.com), 763.442.2849

Kaci Nowicki  
[knowicki@sehinc.com](mailto:knowicki@sehinc.com), 651.894.2508

Ryan Falch  
[rfalch@sehinc.com](mailto:rfalch@sehinc.com), 715.651.1327

Josh Holbrook  
[jholbrook@sehinc.com](mailto:jholbrook@sehinc.com), 608.576.1565

Terminal Building Items Eligible for Federal Funding:	Terminal Building Items Ineligible for Federal Funding:
Interim terminal facility	Administrative office space
Water, sewer, gas, and electric to eligible areas of the building	Conference room(s) and training room(s)
Restroom facilities	Non-fixed furniture
Pilot lounge area	Kitchenette area (e.g., sink, cabinets, and countertop)
Pilot briefing room	Extra space within the mechanical room (e.g., storage space)
Central waiting room/public lounge	Landscaping
Fixed furniture	Utility sink for janitorial purposes
Exterior covered walkway	Exterior seating area (e.g., patio)
Space for vending area (if accessible to public from inside building)	Security cameras and setup
Decorative siding and masonry (if matching existing sponsor facilities and/or surrounding buildings)	Shower facilities
	Janitorial closet
	Hallways to ineligible area(s) in the building



\*Use the QR code to access interviews of the first three selected airport sponsors.





Partnering with you for all your  
airport equipment and service needs.



## Preventive Maintenance

Minimize Lifecycle Costs  
Increase Equipment Longevity  
Scheduled Maintenance Plans

## Asset Management Tool - ALIS

Track all assets and maintenance schedules

## FAA Certified Service

AWOS | RWIS | NAVAID | Control Tower | NADIN  
Embedded light Bolt Torquing | ALCMS  
CCR | PAPI | MALSR



## ATIS Equipment Manufacturer

Control Tower  
Equipment Upgrades  
FCC Licensing

## Runway Friction Measurement Equipment



Experts in RWIS,  
RVR, AWOS  
and LLWAS

[www.dbttranserv.com](http://www.dbttranserv.com) • (844) 343-8328 • [sales@dbttranserv.com](mailto:sales@dbttranserv.com)

# Airport Redevelopment Concerns?

**AECOM Can Manage the Process**

**AECOM**



Enabling any real estate or facility development at an airport requires an environmental assessment. AECOM can manage the environmental impact assessment for the successful development of airport infrastructure and facilities including permit approvals, as well as designing and constructing those improvements.

AECOM is a leader for the management of per- and polyfluoroalkyl substances (PFAS) occurrences at airports stemming from their use in Aqueous Film Forming Foam (AFFF).

## A FULL SUITE OF SERVICES FOR AVIATION AND AIRPORTS

- Airport Planning, Design, and Program Management
- PFAS Investigations and AFFF Management
- Site Assessments – Phase I and Phase II
- Soil and Water Testing
- Wetland Delineation and Mitigation
- Sustainability Consulting
- NEPA Process

**CONTACT US:** [askenvironment@aecom.com](mailto:askenvironment@aecom.com)



[aecom.com/pfas](http://aecom.com/pfas)



[aecom.com/aviation](http://aecom.com/aviation)



## Reaching...

- Airport Officials
- Aircraft Owners
- Airports
- Aircraft Technicians
- Fixed Base Operators
- Flight Schools
- Pilots
- Technical Colleges

**Free Online Magazine**  
**Published for the Midwest Aviation Community Since 1978**

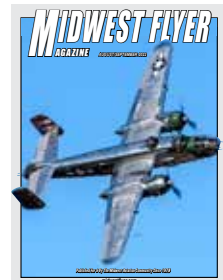

**Contact [dave@midwestflyer.com](mailto:dave@midwestflyer.com)**



**Coffman Associates**  
AIRPORT CONSULTANTS  
[www.coffmanassociates.com](http://www.coffmanassociates.com)

- Master Plans
- Noise Studies
- Land Use Compatibility Studies
- Environmental Documentation
- Feasibility/Site Selection Studies
- Wildlife Hazard Management Plans
- Aviation System Plans
- ALP Narrative Reports
- Benefit-Cost Analysis
- Sustainability Planning
- Safety Management Systems
- AIRSTM - Airport Internet-based Resource Suite
- and more...

We ♥  
Airports





## Runway Status: All Clear

**mb**  
a brand of aebl schmidt

At MB, we're dedicated to providing intelligent, dependable solutions to keep runways and ramps clear and safe.

Our build-to-order approach results in delivering equipment customized to each airport's unique snow removal needs. And when new needs arise, we work to design new solutions.

Comprehensive service, maintenance and training programs round out MB's commitment to our customers, keeping your equipment operating at peak performance so you can meet your airport operations needs.

### MB equipment provides superior runway clearing during the most challenging winter events.

- Blowers
- Plows
- Front Mount Brooms
- Deicers
- Multi-Tasking Equipment

#### Jessie Carr

Sales MB

jessie.carr@aebl-schmidt.com

920-242-4134

Scan to learn more about MB's Airport Maintenance Products.



www.m-bco.com

LET'S START A CONVERSATION.

[www.msa-ps.com](http://www.msa-ps.com)

(800) 362-4505



PLANNING | DESIGN ENGINEERING | CONSTRUCTION ENGINEERING

## Enjoy a smoother journey, start to finish.

By leveraging the latest techniques, maximizing funding, minimizing disruption to your operations and putting our in-depth knowledge of aeronautics standards to work, we deliver airport solutions that benefit your business, your customers and your community.



# WISCONSIN SURPLUS ONLINE AUCTION

[www.WisconsinSurplus.com](http://www.WisconsinSurplus.com)

## LOOKING FOR AN EASY WAY TO DISPOSE OF YOUR UNUSED AND SURPLUS ITEMS? WISCONSIN SURPLUS IS YOUR ANSWER!

### Value, Experience, Audience

We take your descriptions and pictures & sell your items in front of our 142,000+ registered bidders world-wide, at no cost to you!

We have been an online auction service for over 20+ years, specializing in municipal vehicles, equipment & real estate.

Currently, we sell items for municipalities in Wisconsin, Illinois, Iowa, Minnesota and the Upper Peninsula of Michigan.

Discover what other municipalities have already found out—that using Wisconsin Surplus is a simple, convenient & hassle-free way to dispose of your unused and surplus items quickly, and make money doing it!



2005 Kolberg-Pioneer Inc.  
Portable Jaw Crushing Plant  
**\$372,503.00**



63+/- Acre Parcel w/Old Army  
National Guard Vehicle Maintenance  
Shop in Janesville, Wisconsin  
**\$243,500.00**



2013 Western Star 4700 Tandem Axle  
Patrol/Dump Truck  
**\$130,100.00**



2019 Ford F150 XL Supercrew  
4WD Pickup Truck  
**\$61,000.00**

Average 3 Million  
Page Views Per Month

Dedicated Support Staff

Wisconsin State & Local Sales  
Tax Collected and Paid

48 Total Years of Experience in  
the Auction Industry

No Limit on Credit Card  
Purchases

Local Wisconsin Business  
Helping Surrounding  
Communities

Be The Next Success Story  
with Wisconsin Surplus

### WISCONSIN SURPLUS ONLINE AUCTION

PO Box 113  
Mt Horeb, WI 53572  
608-437-2001  
[Bid@WisconsinSurplus.com](mailto:Bid@WisconsinSurplus.com)

[www.WisconsinSurplus.com](http://www.WisconsinSurplus.com)

Monday-Friday: 8am - 4:30pm  
Saturday's: 9am - Noon



## ENERGY OPTIMIZATIONS, DELIVERED.

Veregy is an industry leader in energy efficiency, sustainability, and renewable solutions, serving airports across the nation.



From large hub airport projects, to general aviation, TKDA is there for you.



# *Thank You, Appleton!*



67th

## WISCONSIN AVIATION C O N F E R E N C E

*September 20-22, 2023 · Appleton, WI*



**APPLETON AIRPORT**

GREATER **FOX**  
CITIES  
■ APPLETON WI



# Mead & Hunt

*We believe in going above  
and beyond for clients, and  
our full service aviation team  
is solely focused on  
aviation—it's what we're  
passionate about.*



# WAMA

***Stop by Booth #18 and Meet the Team!***